



JUNE 13-15, 2017

2017 Integrated Public Health and  
Healthcare System Preparedness Summit



POWER IN  
PARTNERSHIPS

building resilient communities

Illinois State University • Bone Student Center • Normal, Illinois

AT-A-GLANCE

[preparednesssummit.illinoisstate.edu](http://preparednesssummit.illinoisstate.edu)

 /IDPH.Illinois

 @IDPH

# Schedule At-a-Glance

**Tuesday, June 13**

---

**7:00 am – 4:30 pm – Registration**

Bone Student Center – Outside Brown Ballroom

**7:30 am – 9:00 am – Continental Breakfast**

Bone Student Center – Brown Ballroom

**9:00 am – 3:30 pm – Special Focus Session**

**Crisis and Emergency Risk Communication (CERC)**

Bone Student Center – Old Main

**Community Assessment for Public Health**

**Emergency Response (CASPER)**

Bone Student Center – Prairie North

**9:00 am – 11:45 am – Learning Symposiums**

**Pharmacists & Pharmacies in Public Health**

**Emergency Preparedness**

Bone Student Center – Prairie South

**SIREN Basic User Hands on Training**

State Farm Hall of Business – 022h

**Communicable Disease Outbreak Preparedness**

**& Management: Identifying Areas of Need and**

**Resources to Respond to Outbreaks**

Bone Student Center – Brown Ballroom

**Saying Goodbye to the Stick and the Carrot: How**

**to Manage a Regional Health Coalition in Illinois**

**When Hospitals are Not Being Directly Funded**

Bone Student Center – Circus Room

**11:45 am – 12:30 pm – Networking Lunch**

Bone Student Center – Brown Ballroom

**12:30 pm – 3:15 pm – Learning Symposiums**

**Mass Casualty Triage and Scene Management**

Bone Student Center – Brown Ballroom

**From DOPE to HOPE**

Bone Student Center – Prairie South

**SIREN Hands on Collaborator Training**

State Farm Hall of Business – 022h

**CEMP New User Training**

State Farm Hall of Business – 022c

# Schedule At-a-Glance

Tuesday, June 13

---

3:15 pm – 5:00 pm - Tour of the ISU EOC  
Meet at Bone Student Center – Outside Brown Ballroom

3:30 pm – 4:45 pm - Learning Workshops

I-TRAIN 3.0 - The New Look and Feel

Bone Student Center – Circus Room

Emerging and Re-emerging Infectious Disease  
Public Health Threats

Bone Student Center – Brown Ballroom

Climate Change Preparedness Activities in Local  
Health Departments: An Evaluations of BRACE-  
Illinois Mini-Grant Project

Bone Student Center – Prairie South

REDCap and ESSENCE

Bone Student Center – Prairie Center

3:30 pm – 5:00 pm - IDPH Director's LHD  
Administrators Meeting

Bone Student Center – Prairie North

3:30 pm – 5:00 pm - MRCIL Annual Meeting

Bone Student Center – Old Main

# Schedule At-a-Glance

Wednesday, June 14

---

7:00 am – 4:30 pm - Registration

Bone Student Center – Outside Brown Ballroom

7:00 am – 7:45 am - Group Exercise (Yoga)

Bone Student Center – 3 West Lounge

7:30 am – 9:00 am - Continental Breakfast

Bone Student Center – Brown Ballroom

8:00 am – 9:00 am - Poster Presentations

Bone Student Center – 1 West Lounge

8:00 am – 5:00 pm - View Exhibits & Posters

Bone Student Center – Brown Ballroom & 1 West Lounge

8:00 am – 3:00 pm - Blood Drive

Bone Student Center – Circle Drive

9:00 am – 11:30 am - Opening Plenary Session

Bone Student Center – Brown Ballroom

11:30 am – 12:30 pm - Lunch

Bone Student Center – Brown Ballroom

12:30 pm – 1:45 pm - Concurrent Track Session 1

T1: How Much of Your Personal Information is Online?

Bone Student Center – Brown Ballroom

T2: When the Crisis Hits, It's Too Late to Build Bridges

Bone Student Center – Circus Room

T3: Organizing a Regional Rescue Task Force: Bleeding Control for Mass Casualty Events

Bone Student Center – Old Main

T4: Post Incident Investigation Policy and Procedure Development for Mass Incidents Involving Children

Bone Student Center – Prairie South

T5: Integrative Emergency Management, A Public Health Perspective and Lessons Learned

Bone Student Center – Prairie Center

T6: Leadership Lessons and Incident Command

Bone Student Center – Prairie North

# Schedule At-a-Glance

Wednesday, June 14

---

## 2:15 pm – 3:30 pm - Concurrent Track Session 2

T1: Youth Mental Health First Aid

Bone Student Center – Brown Ballroom

T2: The 2016 Fight the Bite Cook County:  
A Mosquito Bite Prevention Campaign to Raise  
Awareness About West Nile and Zika Viruses

Bone Student Center – Circus Room

T3: DispenseAssist: A Tool for Improving Your  
Non-Medical Dispensing Throughput

Bone Student Center – Old Main

T4: Disaster Corps: A Disaster Volunteer  
Management Resource

Bone Student Center – Prairie South

T5: Operation Noah's Ark (ONA): Utilizing  
Powerful Faith-Based Imagery and Language  
to Successfully Increase Closed POD and MRC  
Volunteer Recruitment

Bone Student Center – Prairie Center

T6: High volume Hazmat Pediatric Surge

Bone Student Center – Prairie North

## 3:45 pm – 5:00 pm - Concurrent Track Session 3

T1: Community Approach to Active Shooter  
Preparedness: A Multidisciplinary Journey

Bone Student Center – Brown Ballroom

T2: Frenemies: Fostering Mutually Beneficial  
Partnerships with the Media / Shock Wave of  
Social Media

Bone Student Center – Circus Room

T3: The ties that bind: Linking Facility/Agency,  
Local, Regional and State Plans Together

Bone Student Center – Old Main

T4: DuPage County Public Safety Preparedness  
Task Force

Bone Student Center – Prairie South

T5: Organizing and Sustaining Effective  
Community Coalitions

Bone Student Center – Prairie Center

# Schedule At-a-Glance

## Wednesday, June 14

---

**T6: Histo Watcha Ya Know and Watcha Don't Know**  
Bone Student Center – Prairie North

**5:30 pm – 7:30 pm - Welcome Reception & Awards Ceremony**  
Hancock Stadium

## Thursday, June 15

---

**7:00 am – 9:00 am - Registration**  
Bone Student Center – Outside Brown Ballroom

**7:00 am – 7:45 am - Group Exercise (Yoga)**  
Bone Student Center – 3 West Lounge

**7:30 am – 9:00 am - Continental Breakfast**  
Bone Student Center – Concourses 1 East, 2 East, 2 West

**9:00 am – 10:15 am - Concurrent Track Session 4**

**T1: LaSalle County Response to February 28th Tornadoes**  
Bone Student Center – Braden Auditorium

**T2: Enhancing Preparedness: Advancing Collaboration: Maximizing Resources Through the Development of the Web-Based Illinois Conceptual Planning Framework**  
Bone Student Center – Circus Room

**T3: Collaborative Healthcare Coalitions Growth and Expansion**  
Bone Student Center – Old Main

**T4: The Vital Role Community Blood Centers Play During Disaster**  
Bone Student Center – Prairie South

**T5: Flip This House: Renovating your MRC Through Regional Standardization**  
Bone Student Center – Prairie Center

**T6: Leadership Lessons and Incident Command**  
Bone Student Center – Prairie North

**10:30 am – 12:00 pm - Closing Keynote - Who Needs Legs When You Have Wings**  
Bone Student Center – Braden Auditorium

# Bus Schedule

## Tuesday, June 13

From	To	Depart
Doubletree by Hilton Note: 2 buses	BSC - Circle Drive	6:45 am
Marriott / Hyatt Hotels Note: 2 buses will be parked between hotels, load in either one	BSC - Circle Drive	7:00 am
BSC - Circle Drive Note: 2 buses will drop off between hotels	Marriott / Hyatt Hotels	5:15 pm
BSC - Circle Drive Note: 2 buses	Doubletree by Hilton	5:15 pm

## Wednesday, June 14

From	To	Depart
Doubletree by Hilton Note: 2 buses	BSC - Circle Drive	6:45 am
Marriott / Hyatt Hotels Note: 2 buses will be parked between hotels, load in either one	BSC - Circle Drive	7:00 am
BSC - Circle Drive Note: 2 buses will drop off between hotels	Marriott / Hyatt Hotels	5:15 pm
BSC - Circle Drive Note: 2 buses	Doubletree by Hilton	5:15 pm
BSC - Circle Drive Note: 2 buses will make 1 loop	Hancock Stadium	5:15 pm
Hancock Stadium Note: 2 buses	Marriott / Hyatt Hotels	7:15 pm
Hancock Stadium Note: 2 buses	Doubletree by Hilton	7:15 pm

## Thursday, June 15

From	To	Depart
Doubletree by Hilton Note: 2 buses	BSC - Circle Drive	7:30 am
Marriott / Hyatt Hotels Note: 2 buses will be parked between hotels, load in either one	BSC - Circle Drive	7:45 am
BSC - Circle Drive Note: 2 buses will drop off between hotels	Marriott / Hyatt Hotels	12:15 pm
BSC - Circle Drive Note: 2 buses	Doubletree by Hilton	12:15 pm

# ISU Bone Student Center

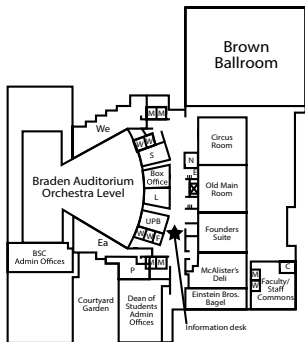

## First Floor (Orchestra)

- C Faculty / Staff Conference Room
- E E-mail Express
- Ea East Lounge
- F Family Restroom
- L Lobby Shop
- M Men's restroom
- N Campus Signage Solutions
- P Programming Office
- S Spotlight Room
- UPB University Program Board
- We West Lounge
- W Women's restroom
- Ⓢ ATM
- ⊠ Elevator

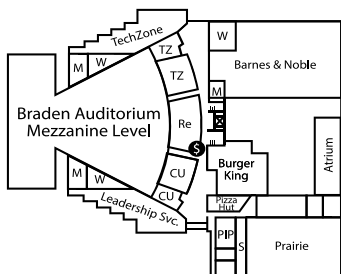

## Second Floor (Mezzanine)

- CU Credit Union
- M Men's restroom
- Re Redbird Card Office
- S Student Involvement Center
- TZ TechZone
- We West Lounge
- W Women's restroom
- Ⓢ ATM
- ⊠ Elevator

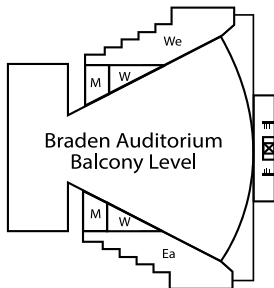

## Third Floor (Balcony)

- Ea East Lounge
- M Men's restroom
- We West Lounge
- W Women's restroom
- ⊠ Elevator