

Preparing for Emerging Threats Through Expanded Partnerships

Summit Program

June 25-27, 2019

Illinois State University Bone Student Center
Marriott Hotel & Conference Center
Normal, IL



PreparednessSummit.ilstu.edu

[@idph](https://twitter.com/idph)

[/idph.illinois](https://facebook.com/idph.illinois)

Schedule At-a-Glance

Tuesday, June 25 - Located at the Bone Student Center

7:00 am – 4:30 pm	Registration
7:00 am – 9:00 am	Continental Breakfast
9:00 am – 3:30 pm	Special Focus Session
9:00 am – 11:45 am	Hands On Learning Symposiums - Located at Heartland Community College
9:00 am – 11:45 am	Learning Symposiums
10:00 am – 11:45 am	CEMP Governance Meeting
10:00 am – 3:00 pm	Blood Drive
11:45 am – 12:20 pm	Networking Lunch
12:30 pm – 3:15 pm	Hands On Learning Symposiums - Located at Heartland Community College
12:30 pm – 3:15 pm	Learning Symposiums
3:30 pm – 5:00 pm	Learning Workshops
3:30 pm – 5:00 pm	MRCIL Annual Meeting
3:30 pm – 5:00 pm	IDPH Director's LHD Administrators Meeting

Wednesday, June 26 - Located at the Marriott Hotel & Conference Center

6:45 am – 7:45 am	Group Exercise (Yoga)
7:00 am – 4:30 pm	Registration
8:00 am – 8:30 am	Poster Presentations
8:00 am – 9:00 am	Continental Breakfast
8:00 am – 5:00 pm	View Exhibits & Posters
8:30 am – 11:15 am	Opening Plenary Session
11:30 am – 12:20 pm	Lunch
12:30 pm – 1:45 pm	Concurrent Session 1
1:45 pm – 2:15 pm	Break - Visit Exhibits and Posters
2:15 pm – 3:30 pm	Concurrent Session 2
3:45 pm – 5:00 pm	Concurrent Session 3

Thursday, June 27 - Located at the Marriott Hotel & Conference Center

6:45 am – 7:45 am	Group Exercise (Yoga)
7:00 am – 10:00 am	Registration
7:30 am – 8:30 am	Continental Breakfast
8:30 am – 9:45 am	Concurrent Session 4
10:00 am – 11:30 am	Closing Keynote
11:45 am – 1:00 pm	Crimson Contagion 2019 Functional Exercise Planning Meeting

Summit Highlights

Summit Purpose

To enable the learner to enhance planning initiatives and solve community preparedness issues.

Location

Tues. 6/25: All events are located at the Bone Student Center, except for 4 pre-conference symposiums, which are located at Heartland Community College.

Wed. 6/26 & Thurs. 6/27: All events are located at the Marriott Hotel & Conference Center.

Bone Student Center

This facility is located on the campus of Illinois State University. Parking is located in the visitor pay lot at \$1 per hour. Inside the Bone Student Center are the following retail shops

Qdoba:	11:00 am – 2:00 pm
Starbucks:	7:30 am – 5:30 pm
The Landing:	7:30 am – 5:30pm

Marriott Hotel

This facility is located in Uptown Normal and within walking distance to several restaurants and retail locations. Inside the Marriott is Jesse's Grille, which is open for breakfast, lunch, and dinner as well as Caffeina's Café which serves Starbuck's Coffee.

Jesse's Grille:	6:30 am – 2:00 pm 5:00 pm – 9:00 pm
Caffeina's Café:	6:00 am – 11:00 pm

Hotel Rooms

It is the responsibility of each participant to make their own room reservations and pay for all room charges, tax, and incidentals. Please see the hotel accommodations information listed on the Summit website.

Meals

Summit registration includes a continental breakfast, boxed lunch, and welcome reception on Tuesday, June 25; continental breakfast and buffet lunch on Wednesday, June 26; and a continental breakfast on Thursday, June 27.

Badges / Scanning

Your Summit badge is your admission to all sessions and activities. Please have your name badge with you at all times as it will be required for scanning purposes throughout the Summit. Badges will be scanned for all concurrent sessions for verification purposes for continuing education credits, as well as tracking for future training needs.

Internet Access

Bone Student Center – Tues. 6/25: There is complimentary WiFi access in all spaces inside the building. When you arrive on campus, you can create your own login from your mobile device.

Marriott Hotel – Wed. 6/26 & Thurs. 6/27: There is complimentary WiFi access in the lobby area and in the meeting room areas. A WiFi code will be provided at the conference registration desk located by Redbird G. WiFi access in guest rooms will be the responsibility of each individual to pay, if needed.

Cell Phones and Pagers

As a courtesy to presenters and your fellow attendees, please turn off cell phones and pagers, or switch to a silent ring mode during all Summit presentations.

Poster Presentations

The posters will be set up at the Marriott in Pre-Function Redbird EF on Wednesday, June 26. Poster authors will be on-site from 8:00 am – 8:30 am to answer any question, but will be left up for viewing until 5:00 pm. Attendees can vote on their favorite poster and the winning author will receive an award.

Exhibits

All exhibits will be available at the Marriott on Wednesday, June 26 from 8:00 am – 5:00 pm.

Blood Drive

The Central Illinois Community Blood Center will be on-site for a blood drive on Tuesday, June 25 at the Bone Student Center from 10:00 am – 3:00 pm. The bloodmobile will be parking in the circle drive area off University St.

Mobile App

The mobile app is called Guidebook and allows you to access maps of each facility, view the program agenda, personalize your own schedule based on the sessions you want to attend, see a list of exhibits, post pictures from the Summit, learn about speakers, and receive real-time alerts and announcements. See page 17 for instructions on how to download the app.

Summit Highlights

Going “Green”

The Summit is committed to promoting and contributing to a clean and safe environment. The planning committee is supporting “green” efforts by reducing the amount of paper handouts, utilizing supplies made of recycled material, offering online evaluations and providing water stations instead of bottled water.

Evaluations

All evaluations will be conducted online. There will be no hard copy handouts of the evaluation tool. The evaluation will be available immediately following the end of the Summit until July 25. If you are requesting continuing education credit, you are required to complete an evaluation in order to be eligible for a certificate. Upon completion of the evaluation, a link to download continuing education certificates will be emailed to eligible participants. Your opinions are valuable and serve to guide planning of future Summits.

Continuing Education Credits

Participants interested in obtaining continuing education credits must visit the continuing education table, located at Registration, to sign in daily. There is no fee for requesting continuing education credits.

Each person seeking continuing education credits is **required** to complete an online evaluation prior to July 25 in order to be eligible for their certificate. Additional information on the evaluation process can be found in the Evaluations section in this program. Upon completion of the online evaluation, eligible participants will be emailed a link to download their certificate.

Continuing education credits will be available for Illinois licensed environmental health practitioners (LEHP), emergency medical technicians (EMT), trauma nurse specialists (TNS), emergency communications registered nurses (ECRN), prehospital registered nurses (PHRN), RN, Illinois licensed nursing home administrators, nurses, and social workers.

This activity has been approved for up to 17.25 clock hours of continuing education for Illinois licensed nursing home administrators, nurses, and social workers by the Illinois Health Care Association an approved sponsor of continuing education by the Illinois Department of Financial and Professional Regulation.

Concurrent Sessions

This year’s Summit offers a top-quality program agenda with more than 20 concurrent sessions centered around five focus areas

T1: Infectious Diseases and Surveillance

Sessions will address emerging and infectious disease threats through disease surveillance, analysis, immunization, and education.

T2: Health Care Coalitions

Sessions will address efforts to enhance public health and healthcare system preparedness through coalition building, collaborations, policy development, performance improvement and sustainability.

T3: Capacity Building

Sessions will focus on the communities’ and healthcare systems’ ability to plan and prepare for an event or incident, and their operational ability to support the event or incident with public health or medical implication.

T4: Current Events and Hot Topics

Sessions will address current priority areas in public health and healthcare coalition preparedness, recent disaster response efforts, vulnerable populations, emerging threats and other critical updates.

T5: Lessons Learned

Sessions will highlight lessons learned and share resources and tools from successful activities in the field related to core capabilities to improve and enhance public health and medical preparedness.

Registration

7:00 am - 4:30 pm

Bone Student Center - Pre-Function (outside Ballroom)

Continental Breakfast

7:00 am - 9:00 am

Bone Student Center - Ballroom III

Special Focus Session

9:00 am - 3:30 pm

Crisis and Emergency Risk Communication (CERC) Course

Bone Student Center - Ballroom II

This training is designed by CDC for public health professionals, medical and health professionals, first responders, community and civic leaders, as well as volunteer organizations at local, state and federal levels. This in-person interactive course gives participants essential knowledge and tools to navigate the harsh realities of communicating to the public, to media, to partners, and to stakeholders during an intense public health emergency. **Pre-registration required; no walk-ins.**

Kellee Waters, EMGSC

Hands on Learning Symposiums

9:00 am - 11:45 am

SIREN Basic User Training

Heartland Community College - ICN 1001

This session will assist attendees by increasing their knowledge in the SIREN system. This will be a hands on live computer training and interactive audience member session that will be targeted for Public Health Employees, Local Health Departments, Hospitals, and Public Health Partners. A demonstration of how SIREN is currently utilized, along with a question and answer format after each section covered. **Pre-registration required; no walk-ins.**

Jennifer Blazis, BS

Tylar Foster, BS

WebEOC Basic User Training

Heartland Community College - ICN 1002

WebEOC is an internet based program that is designed to assist with operations during an emergency response. It provides Incident Command System (ICS) position-specific activity logging and significant event tracking for a real-time common operating picture of the lifecycle of an incident. This hands-on training will provide an overview of the IDPH WebEOC system, instruct users how to navigate the system, and provide step by step instructions on accessing and utilizing WebEOC as an end user. This session is limited to representatives from local health departments and Regional Hospital Coordinating Centers (RHCCs). **Pre-registration required; no walk-ins.**

Tricia Patterson, MS, MT(ASCP)

Kevin Gillespie, LEHP

Learning Symposiums

9:00 am - 11:45 am

Leading Investigations: Building the Capacity to Respond to Healthcare Associated Illnesses Requiring Environmental Assessments and Sampling

Bone Student Center - Ballroom I

Are you ready to investigate? Gain experience in coordinating and conducting environmental investigations of healthcare-associated illness such as Legionnaires disease with a team of IDPHs communicable disease and environmental health professionals. Participate in a hands on demonstration of sampling techniques and an open discussion with a panel of IDPHs CD and environmental health Legionella outbreak response team.

Darrah Dunlap, MPH, LEHP

Judy Kauerauf, MPH

Overview of the City of Chicago DSNS 12-Hour Push Package Deployment

Bone Student Center - Braden

Opportunity for Public Health and Hospital partners to see, touch, evaluate and better understand the re-apportionment of the DSNS 12-hour Push Package compliment of flight containers containing medical material and pharmaceuticals for the treatment of symptomatic patients.

Michael Robbins, PharmD

Christopher Shields, BS, EMT-P

Emily Zaran, MS

Sarah Murray

Learning Symposiums

9:00 am – 11:45 am

Psychological First Aid: Helping Others in Times of Stress

Bone Student Center - 3 East Lounge

A framework for understanding the factors that affect stress responses in disaster relief workers and the clients they serve. Participants engage in practice exercises and a review of the course content.

Marilyn Stevens, LCSW

STOP the Bleed B-CON

Bone Student Center - 3 West Lounge

Uncontrolled bleeding is the number one cause of preventable death from trauma. This course will cover; scene safety, identification of life threatening bleeding and bleeding control techniques. All participants will practice techniques with dressings and tourniquets. There will also be discussion/demonstrations on improvising with common materials such as clothing and bandannas.

Mary Connelly, RN, BSN

Moses Lee, MD

Barbara Oliff, RN, BSN

CEMP Governance Meeting

10:00 am - 11:45 am

Bone Student Center - Spotlight

Blood Drive

10:00 am - 3:00 pm

Bone Student Center - Circle Drive (Bloodmobile parked outside)

Networking Lunch

11:45 am - 12:20 pm

Bone Student Center - Ballroom III

Hands on Learning Symposiums

12:30 pm - 3:15 pm

SIREN Collaborator Training

Heartland Community College - ICN 1001

This session will assist attendees by increasing their knowledge in the SIREN system. This will be a hands on live computer training and interactive audience member session that will be targeted for Public Health Employees, Local Health Departments, Hospitals, and Public Health Partners. A demonstration of how SIREN is currently utilized, along with a question and answer format after each section covered. **Pre-registration required; no walk-ins.**

Jennifer Blazis, BS

Tylar Foster, BS

CEMP New User Training

Heartland Community College - ICN 1002

This in person training is an introduction to the Comprehensive Emergency Management Program (CEMP) platform. The training will cover the basics how tos of navigating and utilizing the system for a new user. The training will cover start with the basics and walk users through the fundamentals of the system followed by an in depth tutorial on how to upload and maintain information in the system. Existing users can also attend for a refresher or ask questions on more advanced topics during the open question and answer session.

John Rogan, MS

Sabeen Shamsi, MS

Learning Symposiums

12:30 pm - 3:15 pm

Exclusion, Isolation, Quarantine and Closure: Are you Prepared and Ready to Implement these Countermeasures and Responses Strategies to Prevent Infectious Disease Transmission?

Bone Student Center - Ballroom I

This session will address infectious disease situations where exclusion, isolation, quarantine, and/or closure are needed. This could be foodborne or healthcare associated outbreaks, or investigation of tuberculosis, novel influenza, measles, or Ebola cases. Past examples of events where these measures were implemented will be presented and discussed. LHDs will have an opportunity to practice scenarios under all four countermeasures strategies to identify their readiness to implement, as well as gaps that need to be addressed and resolved.

Judy Kauerauf, MPH

Jennifer Chacon, RN, BA

Julie Pryde, MPH, MSW

Shana Altman, BS, CHES

CHEMPACK Workshop

Bone Student Center - Circus

This session will provide training for all Illinois CHEMPACK Hospitals, Health Care Coalition members and regional public health emergency management coordinators, and other health professionals who may be involved in responding to a nerve agent incident.

Theresa Tolar, RN, BSN, MBA

Overview of the City of Chicago DSNS 12-Hour Push Package Deployment - REPEAT

Bone Student Center - Braden

Opportunity for Public Health and Hospital partners to see, touch, evaluate and better understand the re-apportionment of the DSNS 12-hour Push Package compliment of flight containers containing medical material and pharmaceuticals for the treatment of symptomatic patients.

Michael Robbins, PharmD

Emily Zaran, MS

Christopher Shields, BS, EMT-P

Sarah Murray

Interdisciplinary Collaboration Between Public Health Nurses and Nursing Students

Bone Student Center - 3 East Lounge

The Fulton County Health Department, the local Medical Reserve Corps (MRC) and Western Illinois University School of Nursing partnered together to enhance the relationship between all three organizations. This partnership is a win-win for everyone by providing clinical activities for nursing students, continuing education for public health staff, and continual engagement activities for the MRC. Plans are being made to initiate relationships with other rural counties and to get student nurses involved during their Junior year. Specific examples will include creative ways that a MRC can use nursing students throughout the semester and ways that nursing schools can assist the MRC and health department.

Patricia Eathington, BSN, MS, DNP, RN

Karol Herink, BM, RN

Pediatric Disaster Triage: JumpSTART Instructor Course

Bone Student Center - 3 West Lounge

JumpSTART is a pediatric triage process that is utilized during a mass casualty event by prehospital personnel, first responders, and other healthcare professionals. This course will provide an overview of the JumpSTART Triage process and hands on training, as well as provide the resources and tools to conduct provider and instructor classes within their organizations and regions.

Annaliza Camia, MSN, RN, CNL, CPEN

Evelyn Lyons, MPH, BSN, RN

Learning Workshops

3:30 pm - 5:00 pm

Moderately and Extensively Drug Resistant Organisms in Long Term Care Facilities: Containment, Control and Outbreak Response Strategies

Bone Student Center - Ballroom I

Moderately and Extensively-drug Resistant Organisms (MDRO/XDRO) such as *Candida auris* and carbapenem-resistant enterobacteriaceae within long-term care facilities are threats to patient safety. The prevention and reduction of MDROs/XDROs in health care settings is a top priority of IDPH and CDC. Local health departments play a critical role in providing recommendations and guidance to facilities when these organisms are identified. In 2018 and 2019, IDPH and local partners investigated a number of complex XDRO/MDRO outbreaks that will be presented along with a review of CDCs containment strategies and basic infection control principles. Additionally lessons learned from these investigations to include the common challenges many long term care facilities and public health agencies face while trying to combat these pathogens.

Elizabeth Soda, MD

Overview of the City of Chicago CHEMPACK Program

Bone Student Center - Circus

Opportunity for Public Health and Hospital partners to see, touch, evaluate and better understand the re-apportionment of CHEMPACK assets (Nerve agent antidote) that may be stored within their jurisdictions and facilities.

Christopher Shields, BS, EMT-P

Michael Robbins, PharmD

Emily Zaran, MS

Edward McCarthy

Tick-Tock: Time for a Tick Talk

Bone Student Center - 3 East Lounge

As small as poppy seeds, ticks can easily go unnoticed. Their presence, however, represents an increasing threat to public health. This presentation will explore known tick species of Illinois, tick niches and their connection to human activities, and the vector capacity of each tick species for disease transmission. Emphasis will be placed on control and prevention techniques for high risk areas. Finally, the potential for novel tickborne disease establishment, invasive tick species introduction, and tick surveillance response in Illinois will be examined.

Samantha Debosik, MS

Judy Kauerauf, MPH

April Holmes, MPH

Building Readiness: Public-Private Information Sharing Partnerships in the Healthcare Sector

Bone Student Center - Ballroom II

This session discusses the information sharing partnerships available to healthcare partners through the Statewide Terrorism & Intelligence Center (STIC) and the Business Emergency Operations Center (BEOC). Highlights of this session include the development of public safety outreach programs, developing trusted relationships, keeping members engaged, as well as lessons learned and best practices for developing and maintaining these programs. Lessons learned about the Illinois Department of Public Health 2014 Ebola preparedness, influenza outbreaks and the Joplin, Missouri, tornado which supported BEOC partners in their business continuity and emergency response decisions and efforts will be discussed.

Ashley Reichert, MS

Kelli Hun, BS

Edie Casella, PMP

Public Health Emergency Response to an Environmental Health Issue

Bone Student Center - 3 West Lounge

In response to an environmental health hazard, the DuPage County Health Department utilized its public health emergency response infrastructure to rapidly assess the situation, develop response objectives, and manage the overall response. Over a period of four months, DCHD drew on expertise from many areas within the health department to respond to community concerns. DCHD will share lessons learned from this activation and identify opportunities to engage environmental health professionals in a response.

Christopher Hoff, MPH

Kevin Dixon

Annual Medical Reserve Corps of Illinois Meeting

3:30 pm - 5:00 pm

Bone Student Center - Spotlight

The annual in-person meeting of the Medical Reserve Corps of Illinois or MRCIL. This will be comprised of guest speakers, as well as a state, regional, and local updates.

Bethanie Albrecht, MS, IPEM

Dawn Davis, RN, BSN, MSN, APRN-BC, CNS

LHD Administrator Meeting

3:30 pm - 5:00 pm

Bone Student Center - Ballroom III

Evonda Thomas-Smith, RN, MSN, DrPH®

Wednesday, June 26

Yoga

6:45 am - 7:45 am

Marriott Hotel - Fell A

Registration

7:00 am - 4:30 pm

Marriott Hotel - Conference Registration Desk (outside of Redbird G)

Poster Presentations

8:00 am - 8:30 am

Marriott Hotel - Pre-Function Redbird EF

Continental Breakfast

8:00 am - 9:00 am

Marriott Hotel - Redbird CD

View Exhibits And Posters

8:00 am - 5:00 pm

Marriott Hotel - Conference Pre-Function Area

Opening Plenary Session

8:30 am - 11:15 am

Marriott Hotel - Redbird CD

Welcome Remarks

Public Health Operational Readiness for All Hazards and Specific Threats

Christine Kosmos, BSN, MS

Lessons Learned from the Sonoma-Napa Fire 2018 and the Camp Fires 2018

Dr. Howard Backer will share California's Public Health and EMS experiences during the wildfires of 2018 including the Sonoma-Napa and Camp Fires. Lessons learned and best practices will be shared in the areas of general medical services, medical shelters, incident management teams, and medical supplies. Shelters in these areas stayed open for nearly a month and lessons learned from the medical issues associated with them, including isolation and infection control, will educate those responding in future disasters.

Howard Backer, MD, MPH, FACEP, FAEMS

Health and Social Services Recovery Methods and Best Practices

Identify and define the health and social services recovery mission and core activities. Provide context and operational concepts for the federal, state, tribal, territorial, and local roles in HSS recovery operations. Explore how local, state, tribal, territorial, federal resources coordinate and collaborate in (and prepare for) recovery efforts. Use best practices to illustrate the process for executing a unified recovery effort.

Joshua Barnes

Lunch

11:30 am - 12:30 pm

Marriott Hotel - Redbird CD

Concurrent Track Session 1

12:30 pm - 1:45 pm

T1: Global Health Threats: Current Day Issues

Marriott Hotel - Redbird G

The purpose of this talk is to review the WHO's defined major global threats, particularly focusing on infectious diseases. Recent examples of how such threats have impacted us at the state and local level will be reviewed, and key preparedness activities highlighted.

Jennifer Layden, MD, PhD

T2: PREPAREDNESS IS KEY: The Journey of Creating a Business Continuity Plan for a Large Healthcare Organization

Marriott Hotel - Redbird B

This session will share the importance of preparedness and journey of creating a robust Business Continuity Plan in the ever-changing healthcare industry. It will share challenges, navigating pitfalls, identification of important partners, and the necessary research to determine what components of a plan would be meaningful to the organization. The presentation also will include how to procure buy in from the executive team, developing strong relationships with Health Informatics Technology and Disaster Recovery, helpful resources regarding project management, and how to hold others accountable for completing respective work product. At the end of the presentation, the completed product will be shared visually, as well as worksheets, annexes and policies that were created.

Lisa Wax, RN, BSN, MHA, CHEC II, CEN, ECRN, TNS

T3: Strategies for Working with the Media During Public Health Events

Marriott Hotel - Redbird F

This session will address how to work with the media during public health events to convey important public health messages. Using recent public health events as examples, IDPH's Public Information Officer will discuss IDPH's approach and lessons learned. This session will provide strategies for communicating public health messages and coordinating with other departments. This session also will address how to responsibly use data to convey magnitude of the problem.

Melaney Arnold, BS

Judy Kauerauf, MPH

T4: 2-1-1: Why Illinois Needs It and What You Can Do to Help

Marriott Hotel - Redbird A

You will have a better understanding on what 2-1-1 is and what it can and cannot provide. 2-1-1 saves time and frustration by eliminating the need for callers to navigate a maze of agencies and help-lines. Specifically, 2-1-1 connects people to social services. 2-1-1 was launched by United Way almost 20 years ago as a free way to connect people to essential resources. Today, 2-1-1 serves more than 283 million Americans -- more than 90% of our population -- in all 50 states, plus Washington DC and Puerto Rico. You will be able to see how to partner with 2-1-1 to ensure Illinois is covered by reviewing how 2-1-1 is partnering with the IDPH on a data dashboard on public health and general social service needs. Finally, you will have an understanding on where in Illinois 2-1-1 is available and where we need help bringing the service to the public.

Gina Strafford-Ahmed, BA, CRS, CCAP, CPM

Concurrent Track Session 2

2:15 pm - 3:30 pm

T1: The Evolving Threat of Vaccine Hesitancy

Marriott Hotel - Redbird G

This talk will address the issue of vaccine hesitancy and the evolving anti-vaccine movement. Recent vaccine preventable disease outbreaks highlights the critical impact this has had on state and local public health. Data regarding vaccine coverage, as well as issues that local health departments face, and potential steps to overcome will be highlighted.

Jennifer Layden, MD, PhD

Julie Pryde, MPH, MSW

Track Key

- T1:** Infectious Diseases and Surveillance
- T2:** Health Care Coalitions
- T3:** Capacity Building
- T4:** Current Events and Hot Topics
- T5:** Lessons Learned

Concurrent Track Session 2

2:15 pm - 3:30 pm

T3: Understanding Public Health Problems Posed by Plumbing: Preparing Beyond the Toolkit

Marriott Hotel - Redbird F

Water is essential to the sanitary operations of healthcare facilities, but water is not sterile. This session will explore the dynamic roles of a successful water management team in responding to building water issues from Legionella to boil orders.

Brian Cox, PE

Darrah Dunlap, MPH, LEHP

T4: Seeing Spots: Measles Considerations for Hospital Providers

Marriott Hotel - Redbird A

Measles may initially look like a viral illness but is highly contagious even before a rash appears. Without a high index of suspicion, a contagious patient's emergency room visit could lead to widespread exposure. Providers must learn to rapidly identify potentially contagious patients and safely manage their care throughout the hospital. Care considerations will also be discussed.

Amy Krupa, MSN, RN, CPEN, CPN, TCRN, TNS, SANE-A, SANE-P

T5: Taylorville Tornado

Marriott Hotel - Redbird E

Overview of the overall response to a local disaster from the prospective of emergency management. Presentation will include the response of all disciplines and the roles they play in the short and long term recovery.

Michael Crews, AAS

Concurrent Track Session 3

3:45 pm - 5:00 pm

T1: Hepatitis A: How a Local Health Department Gets Ahead of the Outbreak

Marriott Hotel - Redbird G

Key takeaways will be how collaboration with community partners can build the infrastructure to reach and instill trust in the vulnerable and marginalized populations. This presentation will stress the importance of going into the community at risk and meeting them where they are at. Participants will also learn the importance of how planning can achieve a successful outcome.

Katie McConnell, BS

Jeanne Jimenez, BSN, RN

Jon Campos, RN

T2: Coalition Response Operations Including Mutual Aid

Marriott Hotel - Redbird B

Inter-operative preparation information to support local medical system response for disasters. Includes healthcare coalitions (HCC) planning, support and deployment that ensures effective, comprehensive, and coordinated response operations. Describe HCC response to emergencies. Illustrate how healthcare organizations connect and collaborate with their local HCC to better understand response and resource capabilities in their area. Describe how HCCs have a direct role in coordinating ESF-8 operations, serve as information sharing and coordinating entities (e.g., patient tracking). Explain roles and responsibilities a HCC serves for coordinating the response. Coalition partners advanced coordination between disciplines response planning.

Kevin Bernard, MOL, EMT-P, CHECIII

T3: Illinois Citizen Corps and Community Emergency Response Team (CERT) Program: What's New?

Marriott Hotel - Redbird F

This session will cover the past and present of the Citizen Corps and Community Emergency Response Team (CERT) programs at the state level. Attendees will learn about the new direction of both programs, as well as hear about other related community preparedness efforts. This session is perfect for those at the local level already involved in the program or those wanting to get started in the program.

Michelle Hanneken, MA, IPEM

Connie Brooks, RN, IPEM

Track Key

T1: Infectious Diseases and Surveillance

T2: Health Care Coalitions

T3: Capacity Building

T4: Current Events and Hot Topics

T5: Lessons Learned

Concurrent Track Session 3

3:45 pm - 5:00 pm

T4: Planning for Vulnerable Populations - The Illinois ESF-8 Plan: Functional and Access Needs/At-Risk Populations Annex, Data Sources, and Other Resources

Marriott Hotel - Redbird A

This session reviews key components in a new Functional and Access Needs Annex to the State ESF-8 Plan. The annex outlines state level response and provides guidance to regions/coalitions on meeting the needs of these populations in a disaster. Data sources that can assist in quantifying the FAN/At-Risk Populations will be reviewed as well as discussion on how that information can be accessed for disaster planning purposes. FAN populations include children, elderly, pregnant women, single-parent households, those with pre-existing health conditions, disabilities or mental health issues, and those with limited English proficiency, homelessness, low socioeconomic status, among others. They will likely require additional assistance before, during or after a disaster event in areas such as communication, transportation, medical care, sheltering and maintaining independence. The needs of these individuals should be integrated at all levels of emergency planning.

Evelyn Lyons, MPH, BSN, RN

Annaliza Camia, MSN, RN, CNL, CPEN

Livia Navon, MS

T5: Planning for Sudden Extreme Surge-Public Health and Medical Preparedness Response Activities and the Route 91 Harvest Music Festival

Marriott Hotel - Redbird E

Successful response to a sudden extreme surge depends on the continued collaboration and preparedness planning efforts of public health, health care and emergency response partners throughout the community. As we identify lessons learned and best practices from responders who have experienced these tragedies first-hand, we increase awareness and guide future planning. As we begin to integrate these lessons and practices into existing plans, we begin to improve and enhance our public health and medical preparedness and response capabilities.

Michelle Seitz, BS, MS

Thursday, June 27

Yoga

6:45 am - 7:45 am

Marriott Hotel - Fell A

Registration

7:00 am - 10:00 am

Marriott Hotel - Conference Registration Desk (outside of Redbird G)

Continental Breakfast

7:30 am - 8:30 am

Marriott Hotel - Redbird CD

Concurrent Track Session 4

8:30 am - 9:45 am

T1: IDPH Infectious Disease Outbreak Plans-HIV, Antibiotic-Resistant Gonorrhea and High Consequence Infections

Marriott Hotel - Redbird G

IDPH staff will share recent surveillance data on HIV and STD trends in Illinois and discuss the lessons learned from the introduction of high consequence infections (MERS, Zika and Ebola). Recently developed IDPH plans to respond to HIV outbreaks, cases of antibiotic-resistant gonorrhea and high consequence infections will be presented. Lastly, strategies for local health departments to utilize, adopt and exercise these plans to meet PHEP grant requirements will be discussed.

Livia Navon, MS

Lori Saathoff-Huber, MPH

Margie Smith, MS, MPH

Track Key

- T1:** Infectious Diseases and Surveillance
- T2:** Health Care Coalitions
- T3:** Capacity Building
- T4:** Current Events and Hot Topics
- T5:** Lessons Learned

Concurrent Track Session 4

8:30 am - 9:45 am

T2: Whole Community Preparedness: Whole Community Coalition

Marriott Hotel - Redbird B

As we strive to plan for whole community preparedness, we must be whole community centric with our partners. We will discuss our strategies and updates to the membership or our coalition. We will discuss our triumphs and struggles to achieve this goal.

Mark Stevens, BS, MPA

Allan C. Ninness, BS

Terry Fulk Jr., BS

T3: Using Preparedness Capacity and Program Partnerships to Respond to a Large-Scale Hepatitis A Outbreak in Michigan

Marriott Hotel - Redbird F

From 2016 to 2018 Michigan experienced its largest ever hepatitis A outbreak. This non-traditional outbreak impacted a variety of Michigan residents including multiple vulnerable populations. The activation of the Community Health Emergency Coordination Center facilitated the coordination of response activities across multiple program areas. These new partnerships are continuing to be developed to facilitate future response activities.

Jay Fiedler, MS

T4: Lessons Learned in Opening a New Hospital: An Emergency Managers Planned Approach to Patient Evacuation and Transport

Marriott Hotel - Redbird A

On January 5, 2019, Javon Bea Hospital staff transported 123 patients to a new Women and Childrens Center across town. The 10 hour transfer process utilized an incident command structure and mimicked a planned evacuation. Over 400 employees, 200+ hours of trainings and exercises led up to the patient transfer day. The 18 months of planning also included surrounding communities, various disciplines and critical emergency management stakeholders. This presentation will share internal plans & processes, lessons learned, and interdependencies across campuses. Additionally, the following areas will be compared to a real-life hospital evacuation; contingency plans, logistical support, patient tracking, communications, triaging, transfer scheduling, and external partners.

Ron Krause, IPEM, Paramedic

Stephanie Kuschel, MPA, CEM, EMT, BS

T5: St. Louis County Department of Public Health: Response to the 2014 Ferguson Civil Unrest & Lessons Learned

Marriott Hotel - Redbird E

This session will allow attendees to listen to actual police radio transmissions of the "Mike Brown" call and how it led into days of riots and civil unrest. You will learn how the St. Louis County Department of Public Health had to adapt and modify their services and responses in order to ensure essentials services were continued for the affected community. And, attendees will learn how this event prompted a new response and recovery protocol specifically for this type of incident.

Ntasiah Shaw, MS, CDP, CEM

Closing Keynote

10:00 am - 11:30 am

Marriott Hotel - Redbird CD

Meet the Speakers

Bethanie Albrecht, MS, IPED

Assistant Program Coordinator -
Medical Reserve Corps

Cook County Department of Public Health

Shana Altman, BS, CHES

Foodborne Disease Coordinator

Illinois Department of Public Health

Melaney Arnold, BS

Public Information Officer

Illinois Department of Public Health

Joshua Barnes

Acting Director

US Department of Health and
Human Services/ASPR

Howard Backer, MD, MPH, FACEP, FAEMS

Director

California Emergency Medical Services
Authority

Kevin Bernard, MOL, EMT-P, CHECIII

Administrative Director EMS and
Emergency Management

Amita St. Mary's Hospital

Jennifer Blazis, BS

HAN Administrator/Coordinator

Illinois Department of Public Health

Connie Brooks, RN, IPED

Director

LaSalle County Emergency
Management Agency

Annaliza Camia, MSN, RN, CNL, CPEN

Pediatric Disaster Preparedness Coordinator

Ann & Robert H. Lurie Children's Hospital
of Chicago / Illinois Emergency Medical
Services for Children

Jon Campos, RN

Infectious Disease Nurse

Adams County Health Department

Eddie Casella, PMP

Project Manager Public-Private Partnerships
and BEOC

Illinois Emergency Management Agency

Jennifer Chacon, RN, BA

Tuberculosis Nurse Consultant

Illinois Department of Public Health

Mary Connelly RN, BSN

Executive Director

IMERT

Brian Cox, PE

Manager, Plumbing and Water
Quality Program

Illinois Department of Public Health

Michael Crews, AAS

Emergency Manager, Fire Chief

Christian County Emergency Management
Agency and Taylorville Fire Department

Dawn Davis, RN, BSN, MSN, APRN- BC, CNS

ESAR-VHP, MRC and Volunteer
Manager Coordinator

Illinois Department of Public Health

Kevin Dixon

Assistant Director of Community
Health Resources

DuPage County Health Department

Samantha Debosik, MS

Vector Control Program Manager

Illinois Department of Public Health

Darrah Dunlap, MPH, LEHP

Water Quality Specialist

Illinois Department of Public Health

Patricia Eathington, BSN, MS, DNP, RN

Associate Professor

Western Illinois University

Jay Fiedler, MS

Division Director, Emergency Preparedness
& Response

Michigan Department of Health and
Human Services

Tylar Foster, BS

HAN / SIREN Program Outreach Specialist

Illinois Department of Public Health

Terry Fulk Jr., BS

RHCC, SPARC President

Southern Illinois Healthcare

Kevin Gillespie, LEHP

Emergency Response Coordinator,
Marion Region

Illinois Department of Public Health

Michelle Hanneken, MA, IPED

Volunteer Programs Manager, Serve
Illinois Commission

Illinois Department of Public Health

Karol Herink, BM, RN

Programs Manager

Fulton County Health Department

Christopher Hoff, MPH

Director of Community Health Resources

DuPage County Health Department

April Holmes, MPH

Vector Control Specialist, Environmental
Health Specialist 3

Illinois Department of Public Health

Kelli Hun, BS

Public Health Intelligence Officer

Illinois Department of Public Health,
Statewide Terrorism & Intelligence Center

Jeanne Jimenez, BSN, RN

Communicable Disease Nurse

Adams County Health Department

Judy Kauerauf, MPH

Communicable Disease Section Chief

Illinois Department of Public Health

Christine Kosmos, BSN, MS

Director of the Division of State and Local
Readiness in the Office of Public Health
Preparedness and Response

Centers for Disease Control and Prevention

Ron Krause, IPED, Paramedic

Emergency Management Specialist

Mercyhealth Javon Bea Hospital

Amy Krupa, MSN, RN, CPEN, CPN, TCRN, TNS, SANE-A, SANE-P

Pediatric Emergency Management
Coordinator

Advocate Childrens Hospital

Stephanie Kuschel, MPA, CEM, EMT, BS

Senior Emergency Management Coordinator
/ Region 1 RHCC / NIPARC Chair

Mercyhealth Javon Bea Hospital / NIPARC

Meet the Speakers

Jennifer Layden, MD, PhD

Chief Medical Officer and State Epidemiologist

Illinois Department of Public Health

Moses Lee, MD

President & Medical Director

Illinois Medical Emergency Response Team

Evelyn Lyons, MPH, BSN, RN

Emergency Medical Services for Children Manager

Illinois Department of Public Health

Edward McCarthy

Coordinator

City of Chicago

Katie McConnell, BS

Emergency Response Coordinator

Adams County Health Department

Sarah Murray

Manager of Emergency Management Services

Chicago Department of Public Health, Public Health and Preparedness Response Program

Livia Navon, MS

Career Epidemiology Field Officer

Illinois Department of Public Health / CDC

Allan C. Ninness, BS

Director

Saline County EMA

Barbara Oliff, RN, BSN

Chief Nurse

IMERT

Tricia Patterson, MS, MT (ASCP)

All-Hazards Planning Section Chief

Illinois Department of Public Health

Julie Pryde, MPH, MSW

Administrator

Champaign-Urbana Public Health Department

Winfred C. Rawls, BBA, MS, MBA

Deputy Director

Illinois Department of Public Health

Ashley Reichert, MS

Critical Infrastructure Specialist

Statewide Terrorism & Intelligence Center

Matthew Ringenberg, MPH

Emergency Response Coordinator

Illinois Department of Public Health

Michael Robbins, PharmD

SNS Director, Projects Administrator / Pharmacist

Chicago Department of Public Health

John Rogan, MS

Principal

Integrated Solutions Consulting

Bill Rowley

Public Information Officer

Aurora Police Department

Lori Saathoff-Huber, MPH

General Epidemiologist, Communicable Disease Section

Illinois Department of Public Health

Michelle Seitz, BS, MS

Health Emergency Response and Preparedness Planner

State of Wisconsin Department of Health Services, Office of Preparedness and Emergency Health Care

Sabeen Shamsi, MS

Consultant

Integrated Solutions Consulting

Ntasiah Shaw, MS, CDP, CEM

Emergency Preparedness Program Manager

Saint Louis County Department of Public Health

Christopher Shields, BS, EMT-P

Assistant Commissioner

Chicago Department of Public Health

Margie Smith, MS, MPH

Surveillance and Evaluation Coordinator

Illinois Department of Public Health

Elizabeth Soda, MD

Medical Officer

Centers for Disease Control and Prevention and Illinois Department of Public Health

Marilyn Stevens, LCSW

Social Worker and Marriage and Family Therapist

Central and Southern Illinois Red Cross Disaster Mental Health

Mark Stevens, BS, MPA

Administrator, Executive Committee

Jefferson County Health Department, Shawnee Preparedness and Response Coalition

Gina Strafford-Ahmed, BA, CRS, CCAP, CPM

Board Chair

2-1-1 Illinois

Evonda Thomas-Smith, RN, MSN, DrPH®

Assistant Director

Illinois Department of Public Health

Theresa Tolar, RN, BSN, MBA

Hospital Preparedness Coordinator

Illinois Department of Public Health

Kellee Waters, EMGSC

Senior Health Communications Specialist

Centers for Disease Control and Prevention (CDC)

Lisa Wax, RN, BSN, MHA, CHEC II, CEN, ECRN, TNS

System Director, Emergency Preparedness

Advocate Aurora Health

Emily Zaran, MS

Senior Emergency Management Coordinator

Chicago Department of Public Health, Public Health Preparedness Response Program

Poster Presentations

An Investigation of Perceived Barriers to Electronic Patient Care Record (ePCR) Reporting by EMS Transport Provider Agencies to the Illinois Department of Public Health (IDPH)

Adrienne Lefevre, MPH, CHES

*Illinois Department of Public Health /
CDC Foundation*

The Illinois EMS Systems Act (210 ILCS 50) and supporting administrative code enable the collection of NEMSIS Version 3-compliant prehospital patient care record data by licensed EMS transport vehicle providers, and the subsequent submission of these data to the Illinois Department of Public Health (IDPH). As of June 10, 2019, among 632 licensed EMS transport provider agencies in Illinois (and IL-licensed providers based in other states), 81.38 percent (n=507) of agencies were submitting records in the current NEMSIS Version 3, less than 1% percent (n=2) of agencies were submitting records in the outdated NEMSIS Version 2, and 18.30 percent (n=114) of agencies were not submitting records to IDPH at all (within the past 60 days). Non-submission, or reporting in dated NEMSIS Version 2, of EMS data is a state-wide problem in Illinois. Non-compliant, licensed EMS transport provider agencies lose out on opportunities for proper oversight, monitoring of important trends (such as the opioid overdose epidemic), and quality improvement and assurance activities. The objective of the investigation was to gather perspectives on barriers, and possible solutions, to utilizing NEMSIS Version 3-compliant software to create electronic patient care records and then submit those records to IDPH.

BREATHE Easier In Power Outage Emergencies: A Power-Packed Preparedness Campaign and Toolkit

Ronda Koch, BS, MS

*Franklin-Williamson Bi-County
Health Department*

"BREATHE Easier in Power Outage Emergencies" is a ready-made "power packed" (pun intended) preparedness toolkit that can help mitigate the impacts of power outage on some of the most vulnerable people in your community - those relying on electrically-operated home medical equipment. This program, developed and vetted by home medical equipment companies and other critical partners, is designed to be championed by companies who provide equipment and services directly to these individuals, see www.BreatheEasyIL.info. As a frequently recurring emergency event and with it linked to many other hazards, tackling power outage health mitigation allows emergency planners to work smart and to concentrate their efforts to enhance community resiliency while building capability across a spectrum of local hazards.

Emergency Preparedness for Public Swimming Facilities

Ashok Gokhale, PhD, PE

Illinois Department of Public Health

The Centers for Disease Control and Prevention (CDC) reports that outbreaks of illnesses associated with swimming facilities are very common. Illinois Dept. of Public Health is responsible for monitoring, inspecting and licensing these facilities. Specific topics that will be discussed include: 1) Maintaining specific levels of pH, free residual Chlorine, Bromine, and re-circulation turnover rate, and 2) Ensuring drain covers are in compliance with Virginia Graeme Baker (VGB) regulations.

Hepatitis A: How a Local Health Department Gets Ahead of the Outbreak

Katie McConnell, BS

Adams County Health Department, Illinois

Jeanne Jimenez, BS, RN

Adams County Health Department

Jon Campos, RN

Adams County Health Department

Key takeaways will be how collaboration with community partners can build the infrastructure to reach and instill trust in the vulnerable and marginalized populations. This presentation will stress the importance of going into the community at risk and meeting them where they are at. Participants will also learn the importance of how planning can achieve a successful outcome.

Impact of Medical Reserve Corps Volunteers in Illinois (June 2018-May 2019)

Bethanie Albrecht, MS, IPHM

Medical Reserve Corps of Illinois

Ben Thompson

McDonough County Health Department

This poster will show a snapshot of what MRC units and volunteers are doing throughout the state of Illinois. It will highlight various activities, awards, economic values, number of volunteers, and hours committed throughout the state.

Poster Presentations

On the EMTrack® Towards Success: Implementing a Patient Tracking System in Chicago

Elisabeth Weber, MA, RN, NHDP-BC, CEN

Chicago Department of Health

Jillian Pateros, MSN, RN

Advocate Illinois Masonic Medical Center

The poster presentation will outline the implementation of the EMTrack® electronic patient tracking system in EMS Region XI (Chicago). The Chicago Department of Public Health (CDPH), in collaboration with Chicago Fire Department EMS and Chicago's 28 acute care hospitals, are piloting the use of EMTrack® through a series of drills and exercises to track patients from field through hospital. Presently, EMS Region XI (Chicago) serves as the first region within the State of Illinois to pilot the use of EMTrack®. The presentation provide an overview on the three region-wide drills that have taken place as well as the results and key lessons learned.

Operation Santa Drop, A Distribution Exercise to Spread Holiday Cheer

Barbara Agor

Will County Health Department

Will County Health Department Medical Reserve Corps and Stickney Public Health District partnered together for the second annual Operation Santa Drop, a distribution exercise that not only spread holiday cheer to United States troops serving overseas, but also tested operations, logistics and inventory management and built capacity of the Medical Reserve Corps. Forty-three volunteers collected 16,725 donated items and packed 113 boxes and prepared boxes which were shipped to six different troops serving overseas in Afghanistan, Kuwait, South China Sea, Bahrain (x2) and Japan.

Pediatric Evacuation: You Don't Get to Go Home But You Can't Stay Here

Amy Krupa

Advocate Childrens Hospital

The size and abilities of pediatric patients can present unique challenges when they must be evacuated from the hospital. Staff may receive little if any pediatric specific evacuation training, and have few opportunities to practice this life saving process. This poster familiarizes the learner with situations when evacuation may be necessary, the roles of nurses and other hospital staff during evacuation, various methods and types of evacuation, equipment appropriate for pediatric evacuation, and special considerations when evacuating pediatric patients. Decisions regarding order of evacuation and post evacuation care will also be highlighted. Specifically, participants will gain a basic understanding of when, where, and how to safely evacuate hospitalized pediatric patients.

2019 IDPH Prep Summit has gone mobile!

Get the app on your mobile device now, for free.

<https://guidebook.com/g/idphprepsummit/>

guidebook

1

Visit the above URL on your device

2

Tap the "download" button to get the free Guidebook app

3

Open Guidebook and look for the guide:

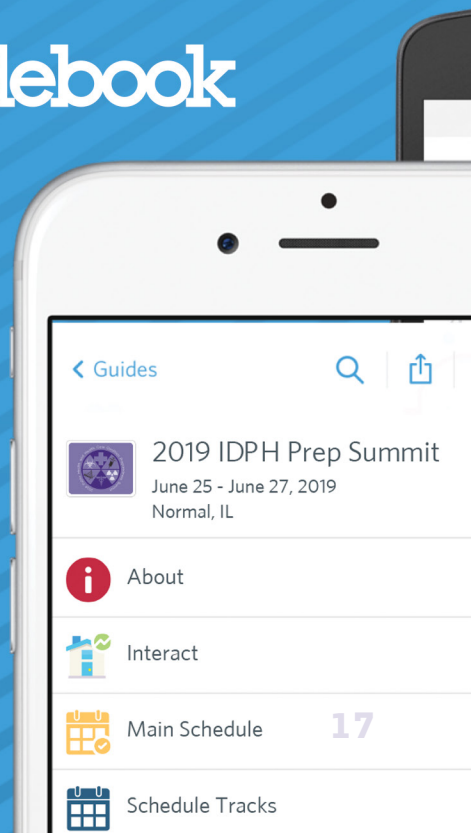

Thank You

Sponsors

Special thanks to our sponsors for their support of the 2019 Public Health and Health Care Coalition Preparedness Summit!

Gold Sponsor



Elliot Data Systems Inc. - Mobile Solutions

Silver Sponsor



Serve Illinois

Exhibits

Special thanks to our exhibitors for their support of the 2019 Public Health and Health Care Coalition Preparedness Summit!

Disaster Management Systems

Illinois EMSC

IMERT

Illinois Coalition of Community Blood Centers

Illinois Rural Health Association

Medical Reserve Corps of Illinois

MedSled

Ragon Communications, Inc.

Statewide Terrorism & Intelligence Center

Z-Medica

Funding for this Summit was made possible (in part) by the cooperative agreement award 6NU90TP921904 from the U.S. Centers for Disease Control and Prevention. The views expressed in written conference materials or publications and by speakers and moderators do not necessarily reflect the official policies of the U.S. Department of Health and Human Services, nor does mention of trade names, commercial practices, or organizations imply endorsement by the U.S. Government.

Thank You

2019 Summit Planning Committee

Thank you to the Summit planning committee for their guidance, suggestions, and efforts that have made this year's Summit one that will benefit all in attendance. Their dedication is truly appreciated!

Winfred C. Rawls, BBA, MBA, MS

Summit Co-Chair

Tammy Moomey

Summit Co-Chair

Michelle Hanneken, MA, IPEM

Steering Committee

Cara Barnett, MPH

Steering Committee

Carolyn Haberman, BS MT(ASCP)

Chair, Infectious Diseases & Surveillance

Sue Hecht, RN, BSN, TNS, IPEM, CHEC III

Chair, Health Care Coalitions

Bethanie Albrecht, MS, IPEM

Chair, Capacity Building

Evelyn Lyons, RN, MPH

Chair, Current Events & Hot Topics

Kevin Gillespie, LEHP

Chair, Lessons Learned

Linda Angarola, RN, BSN

Greg Atteberry, RN, MSN

Jennifer Blazis, BS

Claudia Braden, RN, BSN, MPH

**Annaliza Camia, MSN, RN, CNL,
CPEN**

**Dawn Davis, RN, BSN, MSN,
APRN-BC**

Ellen Genrich, AS, PDS

Mark Hayes

Betty Haynes

**Stephanie Kuschel, MPA, CEN,
EMT, BS**

Amy McCallister, MS, CHES

Dacia Meyers, BS

Livia Navon, MS

Tricia Patterson, MS, MT (ASCP)

**Martha Pettineo, MSN, RN, CEN,
TNS, EMT-P**

Leslee Stein-Spencer, RN, MS

Theresa Tolar, RN, BSN, MBA

Katie Weber, MSPH

Bone Student Center

First Floor

- Barnes & Noble
- Brown Ballroom I, II, & III
- Circus Room
- Courtyard
- Pre-Function Area
- Spotlight Room
- Starbucks
- The Landing

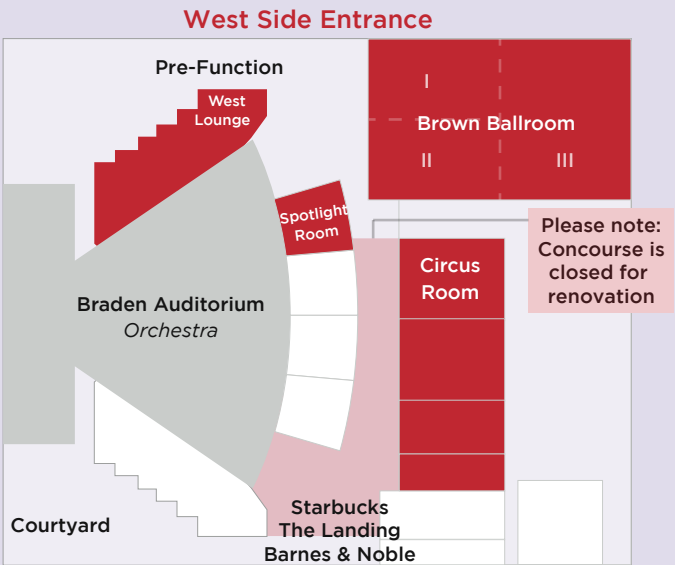

Second Floor

- Qdoba

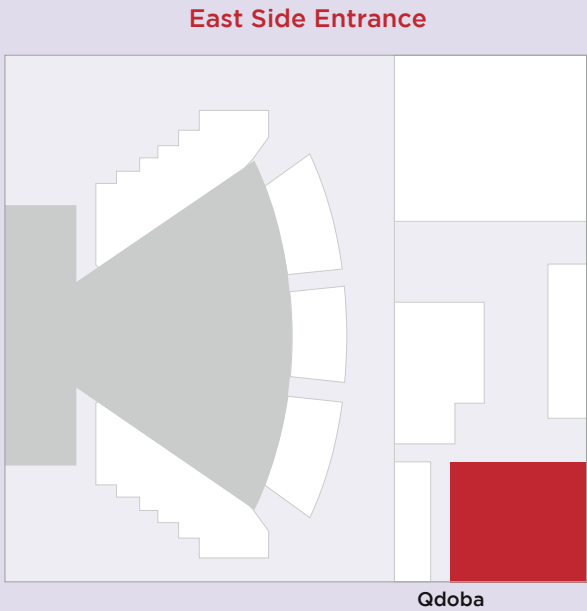

Third Floor

- 3 East Lounge
- 3 West Lounge
- Atrium



Marriott Hotel & Conference Center

SECOND FLOOR

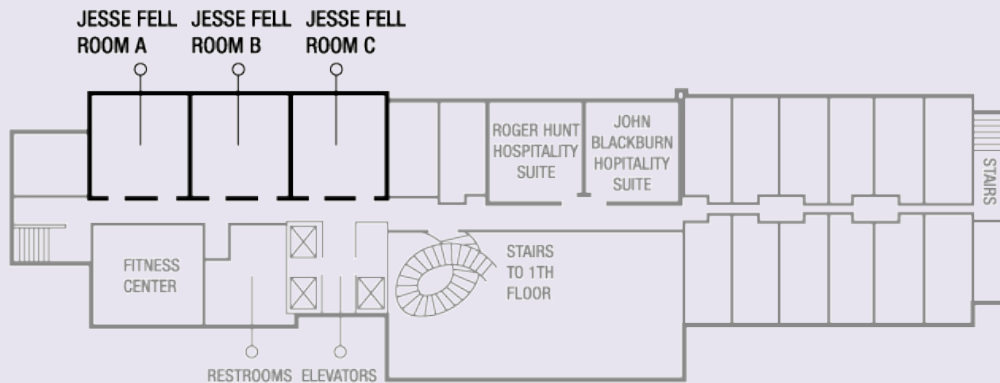

FIRST FLOOR

