

SUMMIT PROGRAM



← LEARNING FROM THE PAST PREPARING FOR THE FUTURE →

**2018 PUBLIC HEALTH AND HEALTH CARE
COALITION PREPAREDNESS SUMMIT**

JUNE 12-14, 2018

MARRIOTT HOTEL & CONFERENCE CENTER • NORMAL, IL

SCHEDULE AT-A-GLANCE

TUESDAY, JUNE 12

7:00 am – 4:30 pm	Registration
7:30 am – 9:00 am	Continental Breakfast
9:00 am – 3:30 pm	Special Focus Session
9:00 am – 11:45 am	Hands On Learning Symposiums
9:00 am – 11:45 am	Learning Symposiums
11:45 am – 12:30 pm	Networking Lunch
12:30 pm – 3:15 pm	Hands On Learning Symposiums
12:30 pm – 3:15 pm	Learning Symposiums
3:30 pm – 4:45 pm	Learning Workshop
3:30 pm – 5:00 pm	IDPH Director's LHD Administrators Meeting
3:30 pm – 5:00 pm	MRCIL Annual Meeting
5:30 pm – 7:30 pm	Welcome Reception & Awards Ceremony

WEDNESDAY, JUNE 13

6:45 am – 7:45 am	Group Exercise (Yoga)
7:00 am – 4:30 pm	Registration
7:30 am – 9:00 am	Continental Breakfast
8:00 am – 8:30 am	Poster Presentations
8:00 am – 5:00 pm	View Exhibits & Posters
8:00 am – 3:00 pm	Blood Drive
8:30 am – 11:30 am	Opening Plenary Session
11:30 am – 12:30 pm	Lunch
12:30 pm – 1:45 pm	Concurrent Session 1
2:15 pm – 3:30 pm	Concurrent Session 2
3:45 pm – 5:00 pm	Concurrent Session 3

THURSDAY, JUNE 14

6:45 am – 7:45 am	Group Exercise (Yoga)
7:00 am – 9:00 am	Registration
7:30 am – 9:00 am	Continental Breakfast
8:30 am – 9:45 am	Concurrent Session 4
10:00 am – 11:30 am	Closing Keynote
11:30 am – 12:00 pm	Book Signing
12:00 pm – 4:30 pm	CRI Meeting

SUMMIT HIGHLIGHTS

SUMMIT PURPOSE

To enable the learner to enhance planning initiatives and solve community preparedness issues.

BADGES / SCANNING

Your summit badge is your admission to all sessions and activities. Please have your name badge with you at all times as it will be required for scanning purposes throughout the summit. Badges will be scanned for all concurrent sessions for verification purposes for continuing education credits, as well as tracking for future training needs.

MEALS

Summit registration includes a continental breakfast, boxed lunch, and welcome reception on Tuesday, June 12th; continental breakfast and buffet lunch on Wednesday, June 13th; and a continental breakfast on Thursday, June 14th.

MARRIOTT INFORMATION

The Marriott Hotel is located in Uptown Normal and is within walking distance to several restaurants and retail locations. Inside the Marriott is Jesse's Grille which is open for breakfast, lunch, and dinner as well as Caffaina's Cafe which serves Starbucks Coffee.

Jesse's Grille: 6:30 am – 2:00 pm
5:00 pm – 11:00 pm

Caffeina's Cafe: 6:00 am – 5:00 pm

HOTEL ROOMS

It is the responsibility of each participant to make their own room reservations and pay for all room charges, tax, and incidentals. Please see the hotel accommodations information listed on the conference website.

INTERNET ACCESS

There is complimentary wi-fi access in the lobby area of the Marriott Hotel. There will also be complimentary wi-fi access in the meeting room areas during Summit each day. A wi-fi code will be provided during check-in when picking up your Summit badge. Wi-Fi access in guests rooms will be the responsibility of each individual to pay for, if needed.

GOING "GREEN"

The summit is committed to promoting and contributing to a clean and safe environment. The planning committee is supporting "green" efforts by reducing the amount of paper handouts, utilizing supplies made of recycled material, offering online evaluations and providing water stations instead of bottled water.

LOCATION

All Summit events are at the Marriott Hotel, except for 4 pre-conference sessions on Tuesday, which are at Heartland Community College.

CELL PHONES AND PAGERS

As a courtesy to presenters and your fellow attendees, please turn off cell phones and pagers, or switch to a silent ring mode during all summit presentations.

POSTER PRESENTATIONS

The posters will be set up in Pre-Function Redbird EF on Wednesday, June 13th. Poster authors will be on-site from 8:00 am – 8:30 am to answer any questions, but will be left up for viewing until 5:00 pm. Attendees can vote on their favorite poster presentation and the winning author will receive an award.

EXHIBITS

All exhibits will be available from 8:00 am – 5:00 pm on Wednesday, June 13th.

WELCOME RECEPTION

Please plan to attend the welcome reception on Tuesday, June 12th from 5:30 – 7:30 pm. Enjoy music and complimentary hors d'oeuvres. Awards will be given out during this event.

BLOOD DRIVE

The Central Illinois Community Blood Center will be on-site for a blood drive on Wednesday, June 13th, from 9:00 am – 3:00 pm.

MOBILE APP

The mobile app is called Guidebook and allows you to access maps of the Marriott Hotel, view the program agenda, personalize your own schedule based on the sessions you want to attend, see a list of exhibits, post pictures from the summit, learn about speakers, receive real-time alerts and announcements and more! See page 18 for instructions on how to download the app and more details.

EVALUATIONS

All evaluations will be conducted online. There will be no hard copy handouts of the evaluation tool. The evaluation will be available until July 16th, immediately following the end of the summit. If you are requesting continuing education credit, you are required to complete an evaluation in order to be eligible for a certificate. Upon completion of the evaluation, a link to download continuing education certificates will be emailed to eligible participants. Your opinions are valuable and serve to guide planning of future summits.

SUMMIT HIGHLIGHTS

CONCURRENT SESSIONS

This year's summit offers a top-quality program agenda with more than 20 concurrent sessions centered around six focus areas:

T1: Current Events and Hot Topics

Sessions will address current priority areas in public health, recent outbreak or disaster response, emerging threats and other critical updates.

T2: Health Care Coalitions

Sessions will address efforts to enhance public health and health care system preparedness through coalition building, collaborations, policy development, training and exercising, and overall performance improvement, and sustainability.

T3: CMS Emergency Preparedness Rule

Sessions will focus on collaboration, preparation and the requirements of the CMS Rule and how provider types can integrate into and become active participants in the Health Care Coalitions within their respective regions.

T4: Capacity Building

Sessions will focus on the communities and health care systems ability to plan and prepare for an event or incident, and their operational ability to support the event or incident with public health or medical implications.

T5: Functional and Access Needs/At-Risk Populations

Sessions will focus on recognizing vulnerable populations within communities, integrating their needs into emergency planning, and identifying organizations/resources that can assist these populations both during and after a disaster. Functional and Access Needs (FAN)/At-Risk Populations are typically categorized by age, diverse cultures, economically disadvantaged, those in institutionalized settings/congregate care, isolation, language/literacy issues, and those with medical needs/conditions and/or disabilities.

T6: Recovery

Sessions will focus on efforts to support the whole community recovery post-disaster, including identifying recovery priorities, strategies, issues and challenges, and recovery solutions to reduce current and future risk.

CONTINUING EDUCATION CREDITS

Participants interested in obtaining continuing education credits must visit the continuing education table, located by the Registration Desk, to receive a Continuing Education Credit Application. Dependent upon which type of credit you are seeking, you may be required to sign in daily. There is no fee for requesting continuing education credits. The Continuing Education Credit Application must be returned prior to leaving the summit.

Each person seeking continuing education credits is required to complete an online evaluation prior to July 16 in order to be eligible for their certificate. Additional information on the evaluation process can be found in the Evaluations section on the previous page. Upon completion of the online evaluation, eligible participants will be emailed a link to download their certificate.

Continuing education credits will be available for Illinois licensed environmental health practitioners (LEHP), emergency medical technicians (EMT), trauma nurse specialists (TNS), emergency communications registered nurses (ECRN), prehospital registered nurses (PHRN), RN, Illinois licensed nursing home administrators, nurses and social workers.

This activity has been approved for up to 17.25 clock hours of continuing education for Illinois licensed nursing home administrators, nurses and social workers by the Illinois Health Care Association an approved sponsor of continuing education by the Illinois Department of Financial and Professional Regulation.

REGISTRATION

7:00 am - 4:30 pm

Conference Registration Desk (Outside of Redbird G)

CONTINENTAL BREAKFAST

7:00 am - 9:00 am

Redbird CD

SPECIAL FOCUS SESSION

9:00 am - 3:30 pm

Crisis and Emergency Risk Communication (CERC) Course Redbird A

This training is designed by CDC for public health professionals, medical and health professionals, first responders, community and civic leaders, as well as volunteer organizations at local, state and federal levels. This in-person interactive course gives participants essential knowledge and tools to navigate the harsh realities of communicating to the public, to media, to partners and to stakeholders during an intense public health emergency, including terrorism. The course consists of modules in Crisis Communication for all phases of disaster response; Psychology and use of Risk Communication Principles in a Crisis; Working with the Media in a Crisis; Spokesperson Trust and Credibility in a n Emergency; Crisis Communication Plans; Social Media; Messages and Audience Needs in a Crisis; and Meeting Partner and Stakeholder Needs.

Pre-registration required; no walk-ins.

Caitlyn Lutfy, MPH

HANDS ON LEARNING SYMPOSIUMS

9:00 am - 11:45 am

SIREN Basic User Training Heartland Community College - ICN 1001

This session will assist attendees by increasing their knowledge in the SIREN system. This will be a hands on live computer training and interactive audience member session that will be targeted for Public Health Employees, Local Health Departments, Hospitals, and Public Health Partners. A demonstration of how SIREN is currently utilized, along with a question and answer format after each section covered.

PLEASE BRING A CELLULAR DEVICE TO CLASS

Pre-registration required; no walk-ins.

Jennifer Blazis, BS

Dacia Meyers, BS

Tylar Foster, BS

WebEOC Basic User Training Heartland Community College - ICN 1002

WebEOC is an internet based program that is designed to assist with operations during an emergency response. It provides Incident Command System (ICS) position-specific activity logging and significant event tracking for a real-time common operating picture of the life-cycle of an incident. This hands-on training will provide an overview of the IDPH WebEOC system, instruct users how to navigate the system, and provide step by step instructions on accessing and utilizing WebEOC as an end user. This session is limited to representatives from local health departments and Regional Hospital Coordinating Centers (RHCCs).

Tricia Patterson, MS, MT(ASCP)

LEARNING SYMPOSIUMS

9:00 am - 11:45 am

Understanding the Role and Function of Communicable Disease Surveillance and Control for Administrators & ERCs Redbird B

Single cases or outbreaks of communicable disease can quickly become a public health emergency for local health jurisdictions. This session will highlight the keys to conducting thorough disease surveillance, implementing appropriate control measures, and controlling and preventing disease in your jurisdiction. Topic areas will include communicable disease rules, disease reporting and investigations, releasing data, applying control measures, and managing outbreaks.

Judy Kaverauf, MPH

Lori Saathoff-Huber, MPH

Dawn Nims, MPH

Jodi Morgan, BSN, CIC

LEARNING SYMPOSIUMS

9:00 am – 11:45 am

Preparing Public Health Nurses for Disaster Preparedness, Response, and Recovery

Redbird E

This is an interactive workshop for public health nurses that utilizes evidenced based, active learning strategies to develop knowledge, skills, and abilities related to disaster preparedness, response, and recovery. During the workshop, learners will work as a team to identify the relationship between the nursing process and the disaster management cycle, develop a rapid assessment tool to determine access and functional needs of shelter occupants, and evaluate ethical and legal dilemmas that arise during disasters.

Susan Tracy, BSN, RN

STOP the BLEED—Save a Life

Redbird F

One of the most common causes of preventable death after traumatic injury is uncontrolled bleeding. YOU can help save lives. Learn what to do before help arrives. WARNING: some images are graphic.

Mary Connelly RN, BSN

Moses Lee MD

Rend Lake Water Emergency

Redbird G

On May 16, 2018, the Rend Lake Water Conservancy District, which supplies water to more than 175,000 people in southern Illinois, experienced a major water main break in a 36" steel pipe. This water interruption impacted nine southern Illinois counties. The severity of the break resulted in businesses and facilities throughout southern Illinois closing down. Water was restored on May 18th, but residents continued to be under a boil order for at least two more days. Governor Bruce Rauner issued a disaster proclamation for 9 southern Illinois counties. The SPARC Coalition will hold a panel presentation on the recent water supply disruption to discuss water distribution system, impact of the disruption, and future planning needs.

Terry L. Fulk Jr., RHCC

Ryan Buckingham

Matt Warren

Anthony Volkert

Brad Campbell

Larry Sanders

Marshall Snyder

NETWORKING LUNCH

11:45 am - 12:30 pm

Redbird CD

HANDS ON LEARNING SYMPOSIUMS

12:30 pm - 3:15 pm

SIREN Collaborator Training

Heartland Community College - ICN 1001

This session will assist attendees by increasing their knowledge in the SIREN system. This will be a hands on live computer training and interactive audience member session that will be targeted for Public Health Employees, Local Health Departments, Hospitals, and Public Health Partners. A demonstration of how SIREN is currently utilized, along with a question and answer format after each section covered.

PLEASE BRING A CELLULAR DEVICE TO CLASS

Pre-registration required; no walk-ins.

Jennifer Blazis, BS

Tylar Foster, BS

Dacia Meyers, BS

CEMP New User Training

Heartland Community College - ICN 1002

This in person training is an introduction to the Comprehensive Emergency Management Program (CEMP) platform. The training will cover the basic how to of navigating and utilizing the system for a new user. The training will cover start with the basics and walk users through the fundamentals of the system followed by an in depth tutorial on how to upload and maintain information in the system. Existing users can also attend for a refresher or ask questions on more advanced topics during the open question and answer session.

John Rogan, MS

Sabeen Shamsi, MS

LEARNING SYMPOSIUMS

12:30 pm - 3:15 pm

Illinois HELPS System Administrator Training

Redbird B

The training session will provide instruction and demonstration of all registration and administrative features of the site including managing organizations, managing volunteers accounts, creating and managing notifications to volunteers, and creating and managing volunteer deployments. Participants will need a computer and internet connection.

Dawn Davis, ESAR-VHP, MRC

Jan’Nita D. Caine, RN, BSN, MSN

Before Interdiction: Preventing Targeted Violence through Early Intervention

Redbird E

Mass casualty attacks, violent hate crimes, and acts of terrorism can be prevented. Each is a low frequency - high impact crime. Each is treated separately, but all three are examples of targeted violence. Targeted violence, like other forms of violence can be prevented. The conversation around prevention needs to be broadened. Violence is interconnected. The conversations around preventing bullying, sexual assault, and gang violence for example, can be applied to preventing targeted violence as well. Individuals rarely “snap” and perpetrators often display concerning or warning behaviors. How can we better notice the clues, put them into context, and then act to get help for the person long before interdiction is even an issue?

Junaid Afeef, JD

COALition: A Whole Community Approach to Functional and Access Needs

Redbird F

Using the mnemonic COAL (Convene, Organize, Align, and Listen) from the word “Coalition,” participants will learn basic steps in integrating a whole community approach to Functional and Access Needs planning on a regional basis.

Ronda Koch, BS, MS

Robert Hyman, MS, NR-P

Daniel Hyson BS, MPH

LEARNING WORKSHOPS

3:30 pm - 4:45 pm

Liability protections for selected volunteers under the Good Samaritan and Emergency Management Agency Acts

Redbird B

The presentation will review 21 different Illinois laws that grant licensed but uncompensated healthcare professionals and others limited immunity from paying civil damages under theories of ordinary negligence for acting in emergency situations under the Illinois Good Samaritan Acts and the Illinois Emergency Management Act.

Jonathan Gunn, JD, MICT

Jennifer Johnson, JD

Beyond Chicken New Challenges to Food Safety and Foodborne Outbreak Investigations

Redbird E

New challenges to food safety have emerged in recent years. Changes in food preferences, food production and supply, and new and emerging foodborne pathogens all play a role. These challenges affect the way in which public health approaches and investigates foodborne outbreaks. This presentation will discuss these changes to food safety and the impact on foodborne outbreak investigations. Examples of outbreaks will be provided and areas where response planning is important will be discussed.

Lori Saathoff-Huber, MPH

Shana M. Altman, BS, CHES

Blowing the LID Off Information Silos

Redbird F

The LID is a virtual community where public safety convenes to report, examine, share, and consume information. Data that feeds the LID comes from public safety participants as well as what the Department of Homeland Security (DHS) / Homeland Security Information Network (HSIN) and the Statewide Terrorism & Intelligence Center (STIC) have assembled in the portal.

Alana Sorrentino, BS

LEARNING WORKSHOPS

3:30 pm - 4:45 pm

1 Year Update of the CMS EP Rules Roll Out Redbird A

Presentation on CMS Rule Updates and ASPR TRACIE website. Interactive discussion with panel members.

Joe Ramos, RN, BSN
Michael Borcky

Shannon Wilson, RN, BSN, MS, CHEC II

Integration of Normal and Emergency Public Health Preparedness Programs Beaufort

PHEP incorporates various and comprehensive activities that involves interaction with numerous sectors. Preparedness or response operations require the ability to engage all stakeholders; gather intelligence in real time; maintain version control; and share information and develop operational capability based plans between all stakeholders through a secure web-based Knowledge Management System. The Winnebago County Health Department (WCHD) utilizes a Web-based Knowledge Management System and has been able to standardize , integrate and share planning.

Theresa James, EMD, CHEC

MEDICAL RESERVE CORPS OF ILLINOIS ANNUAL MEETING

3:30 pm - 5:00 pm

Normal Theater

Dawn Davis, ESAR-VHP, MRC

Bethanie Albrecht, MS, IPEM

LHD ADMINISTRATOR MEETING

3:30 pm - 5:00 pm

Redbird G

Donald Kauerauf

RECEPTION / AWARDS CEREMONY

5:30 pm - 7:30 pm

Redbird C

WEDNESDAY, JUNE 13

SUNRISE YOGA

6:45 am - 7:45 am

Fell A

REGISTRATION

7:00 am - 4:30 pm

Conference Registration Desk (Outside of Redbird G)

POSTER PRESENTATIONS

8:00 am - 8:30 am

Pre-Function Redbird EF

CONTINENTAL BREAKFAST

8:00 am - 9:00 am

Redbird CD

BLOOD DRIVE

8:00 am - 3:00 pm

Bloodmobile (parked on Fell St – exit by Redbird G)

VIEW EXHIBITS AND POSTERS

8:00 am - 5:00 pm

Conference Pre-Function Area

OPENING PLENARY SESSION

8:30 am - 11:30 am

Redbird CD

Welcome Remarks

The PHEP Program: Current and Future Direction

Christine Kosmos, BSN, MS

October 1, 2017 Las Vegas Mass Shooting Incident

Todd Nicolson, MA

The importance of the healthcare coalitions during response with emergency management organization, healthcare, law enforcement, and fire.

LUNCH

11:30 am - 12:30 pm

Redbird CD

Performance Management – A Light-Hearted Trip Back to the Basics

Douglas E. Minter, MBA

CONCURRENT TRACK SESSION 1

12:30 pm - 1:45 pm

T1: Ebola and Highly Infectious Disease Preparedness

Fell C

Representatives from Carle Foundation Hospital will present an overview on Ebola preparedness at Carle, transitioning from an Ebola Assessment Hospital to an Ebola Treatment Center. The presentation will also include expanding the preparedness program to include preparation to other highly infectious diseases.

Anita Guffey, EMT-Paramedic, CHEC

Casey McCartney

T1: Synthetic Cannabinoids: How we applied an Infectious Disease model to address this outbreaks and lessons learned about responses from working with law enforcement, hospitals and treatment shortages

Redbird A

In the spring of 2018, the Illinois Department of Public Health (IDPH) investigated a large cluster of patients suffering from unusual bleeding after using synthetic cannabinoids (SCs). The cluster was a significant public health concern due to uncertainty of which products were contaminated, severity of illness, and related pressures on trauma centers. The traditional epidemiological response model worked well for quickly identifying new cases, communicating with providers and the media, and collecting needed information to provide situational awareness. However, several aspects of this investigation presented unique challenges to state and local health departments. Multiple systems were employed to identify cases, from poison control reporting, death records, coroner reports, syndromic surveillance, and reporting from ED physicians. As of May 16, 164 cases, including four deaths, have been reported to IDPH. The involvement of law enforcement agencies was also unique and was crucial to getting product off the streets and preventing additional illnesses.

Judy Kauerauf, MPH

Erin Moritz, PhD

Livia Navon, MS

Donald Kauerauf

T2: Mass Casualty Incident Management: Are We Ready???? - To Respond Beyond our Daily Practice

Redbird B

MCI Management: What we think we are prepared for and what we really are prepared for. MCI Management Planning. Real world demands of resources vs perceptions. Planning and Execution of a Full Scale Exercise: Making an impact that goes beyond the exercise. Lessons learned will direct and create change moving forward.

Stephanie Whitten, PM, CHEC III

T3: CMS Requirements / Regulations of Pediatric Care and Special Populations - Hospital Preparedness Program

Redbird E

Distribute information regarding CMS requirements related to pediatric and Special population response regulation tying in EMSC and HCC.

Kevin Bernard, BA, MA

TRACK KEY

T1: Current Issues & Hot Topics

T2: Health Care Coalitions

T3: CMS Emergency Preparedness Rule

T4: Capacity Building

T5: Functional and Access Needs / At-Risk Populations

T6: Recovery

CONCURRENT TRACK SESSION 1

12:30 pm - 1:45 pm

T4: Syndromic Surveillance in Illinois: An overview and demonstration Redbird F

An overview and demonstration of syndromic surveillance in Illinois. This will include information on the background of what data is collected, how it is used. The presentation will include information on understanding the data and a demonstration for how state and local health department staff can use the syndromic surveillance system. It will incorporate how syndromic surveillance information is combined with data collected in other systems for more informed surveillance and response.

Stacey Hoferka, MPH, MSIS

T5: COALition: A Whole Community Approach to Functional and Access Needs Redbird G

Using the mnemonic COAL (Convene, Organize, Align, and Listen) from the word "Coalition," participants will learn basic steps in integrating a whole community approach to Functional and Access Needs planning on a regional basis.

Ronda Koch, BS, MS

Robert Hyman, MS, NR-P

Daniel Hyson, BS, MPH

T6: Disaster Recovery: Resuming Normal Operations Normal Theater

In the wake of disaster, you have to keep one eye on the crisis event and another eye on operations. Knowing when and how to resume operations may not be overly clear. This is particularly true when the crisis is evolving. The presenter will discuss the aftermath of Hurricane Harvey and the lasting effects on the community of Southeast Texas, with particular attention to the effect on healthcare infrastructure. Hurricane Harvey brought rising flood waters, the loss of potable water and the evacuation of a 500-bed acute care facility. The lessons learned from a multi-staged recovery are serving as a blueprint in preparing for future crisis and regional emergencies.

Todd Senters, MHA, FACHE

CONCURRENT TRACK SESSION 2

2:15 pm - 3:30 pm

T1: Measles: The Peace of Being Prepared for That Call Redbird A

Measles, a highly contagious vaccine preventable disease, is still commonly transmitted in many parts of the world, and as a result, measles cases and outbreak occur each year in the United States. Each year, the Illinois Department of Public Health receives notification of possible measles cases and contacts, and local public health agencies and healthcare partners must respond rapidly to reduce the risk of exposure to others. This presentation will discuss how public health and healthcare partners should initially respond to a reported measles case as well as subsequent evidence-based activities to prevent measles transmission and outbreaks.

Jodi Morgan, RN, BSN, CIC

T2: You Offer Continuing Ed? A Carrot for MRC Capacity Building Redbird B

We will discuss the initiative of the Northern Illinois Public Health Consortium to align their MRC requirements and application in order to assist units with crossover in an emergency. In addition, we have begun a program to offer continuing education hours for professionals who attend the meetings as well as for planned exercises. The session will discuss how we have utilized in-house personnel to present programs that are interesting and thought-provoking to bring people through the door.

Claudia Braden, BSN, MPH

T3: The CMS EP Rules Engagement: A Long-Term Care's Perspective Redbird E

This presentation will look at the steps taken by one long-term care facility in Chicago in response to the CMS EP Rules. Beginning with the initial announcement of the rules, through process of updating our EOPs, joining the Chicago Healthcare Coalition, drafting annexes, to participating in City Wide Full-Scale exercises with other healthcare facilities within the Chicago area.

Mark McCarville, EMT-B

TRACK KEY

T1: Current Issues & Hot Topics

T2: Health Care Coalitions

T3: CMS Emergency Preparedness Rule

T4: Capacity Building

T5: Functional and Access Needs / At-Risk Populations

T6: Recovery

CONCURRENT TRACK SESSION 2

2:15 pm - 3:30 pm

T4: CASPER: The Friendly CDC Assessment Tool

Redbird F

We will discuss how a small rural health department was able to leverage local and regional resources to gain valid, representative data on community preparedness, health behaviors and community perceptions. The session will highlight methods and techniques that worked well for conducting a CASPER as well as identify tools that made implementing CASPER at our local health department easier and more efficient.

Ellen Genrich, AS, PDS

Amanda Mehl, RN, MPH

T5: Prevent legionella and other waterborne outbreaks now with solid water management planning; what every hospital, LTC and LHD needs to know and practice

Redbird G

Healthcare facilities play a critical role in preventing, containing and responding to Legionella cases. Because healthcare facilities typically care for patients in many if not all of these categories, prevention and control measures for Legionellosis are extremely important. Through a nine step process, the CDC toolkit allows each facility to assess and plan for its unique water management situation.

Judy Kauerauf, MPH

Darrah A. Dunlap, MPH, LEHP

CONCURRENT TRACK SESSION 3

3:45 pm - 5:00 pm

T1: Surviving an Active Shooter situation. Ensuring your patients and employees go home at night

Redbird A

How can you prepare your organization, employees, patients or community for an active shooter situation? Teaching run, hide, fight and what to do in each situation. Practicing it like its really happening and preparing the organization in its response will help to prepare you to lock your organization down and send employees, customers, patients home alive at night.

Amanda Payne, EMT-P, RRT

Mandy Sebeschak, CRT

Rick Robbins

T2: In the Eye of The Storm: Evacuating an Acute Care Facility

Redbird B

Managing an acute care facility during a time of crises is challenging, particularly when there is a loss of essential utilities. The presenter will speak on lessons learned by one hospital in the aftermath of Hurricane Harvey. Evacuating a facility in a time of emergency is a challenging decision. This is especially true when your facility serves as a safety net for those most in need. Internal communication during a disaster is essential. Managing external communication is an even greater challenge, and can prove to be even more vital.

Todd Senters, MHA, FACHE

T3: Does Your Home Health Agency Understand the New Requirements for Emergency Preparedness and Conditions of Participation

Redbird E

As of November 15, 2017 home health agencies must be fully compliant with all applicable federal, state, and local emergency preparedness requirements. The conditions of participation went into affect in January of 2018. This interactive discussion is to help home health agencies review the new emergency preparedness requirements and conditions of participation to better prepare each other for their next survey.

Amy McCallister, MS

Joe Ramos, RN, BSN

TRACK KEY

T1: Current Issues & Hot Topics

T2: Health Care Coalitions

T3: CMS Emergency Preparedness Rule

T4: Capacity Building

T5: Functional and Access Needs / At-Risk Populations

T6: Recovery

CONCURRENT TRACK SESSION 3

3:45 pm - 5:00 pm

T4: Operation Santa Drop: A Distribution Exercise to Spread Holiday Cheer Redbird F

In an effort to exercise with real product and remove some of the exercise artificialities of exercising logistics and distribution with empty boxes, Will County Health Department and Stickney Public Health District exercised its distribution plans with donations collected from its Adopt a Military Unit Initiative. This presentation will provide an overview on how WCHD and SPHD inventoried, repackaged, tracked, and shipped donations to its adopted military units worldwide. Using this model, LHD's and MRC volunteers are able to spread holiday cheer while fulfilling PHEP grant exercise requirements.

Katie Weber, MSPH
Daniel Reilly, MPA

Patricia Kulikauskas, MPH

T5: Hepatitis A Outbreak Are We Prepared? A look into the Chicago Department of Public Health's Response Efforts Redbird G

Since March 2017, CDC has confirmed a number hepatitis A outbreaks around the U.S., primarily among people who are homeless and / or use injection and non-injection drugs. In October 2017, the Chicago Department of Public Health (CDPH) identified their first cases of hepatitis A in homeless individuals in the setting similar to the several large hepatitis A outbreaks. We will be highlighting the efforts and collaborations that took place between CDPH, local hospitals and community partners that helped prevent a large outbreak among this at-risk population. This session will also discuss the hepatitis A virus, identify at-risk populations for hepatitis A, and review what Illinois' Hospital EDs and local health jurisdictions should be doing to prepare for and prevent a hepatitis A outbreak situation through education, vaccination and active surveillance activities.

Dawn Nims, BS, MPH

Saul Ayala, MPA

THURSDAY, JUNE 14

YOGA FOR ALL

6:45 am - 7:45 am

Fell A

REGISTRATION

7:00 am - 12:00 pm

Conference Registration Desk (Outside Redbird G)

CONTINENTAL BREAKFAST

7:00 am - 8:00 am

Redbird CD

CEMP GOVERNANCE MEETING

7:30 am - 8:30 am

Fell C

In-Person CEMP Governance Meeting

Matthew Ringenberg, MPH

John Rogan, MS

CONCURRENT TRACK SESSION 4

8:30 am - 9:45 am

T1: Interoperable Communications During an Emergency or Large Scale Event Redbird A

A large scale event or disaster can quickly overwhelming your communications abilities. The State of Illinois' Strategic Technology Reserve has a number of assets that can assist you. ITECS (IL Transportable Communications Suites), UCP's (Unified Command Posts), COML's (Communications Unit Leaders), and AUXCOMM (Amateur Radio) can all assist you in resuming communications or enable you to communicate with responding agencies. This presentation will review the STARCOM21 statewide radio platform and describe the capabilities of STR assets (ITECS, UCP, COML, AUXCOMM) and how they can assist your communications needs.

John Nebel, IPEM, COML

TRACK KEY

T1: Current Issues & Hot Topics

T2: Health Care Coalitions

T3: CMS Emergency Preparedness Rule

T4: Capacity Building

T5: Functional and Access Needs / At-Risk Populations

T6: Recovery

CONCURRENT TRACK SESSION 4

8:30 am - 9:45 am

T2: You Offer Continuing Ed? A Carrot for MRC Capacity Building Redbird B

We will discuss the initiative of the Northern Illinois Public Health Consortium to align their MRC requirements and application in order to assist units with crossover in an emergency. In addition, we have begun a program to offer continuing education hours for professionals who attend the meetings as well as for planned exercises. The session will discuss how we have utilized in-house personnel to present programs that are interesting and thought-provoking to bring people through the door.

Claudia Braden, BSN, MPH

T3: Skilled Nursing Facilities Are you Prepared? Redbird E

Panelist will present on Health Care Coalitions in Illinois and reinforce the need for "collaboration" to establish a more coordinated and defined response to disasters and be prepared and the "Providers Perspective" on this new rule.

Joy Ward, RN, BSN, RAC-CT, LNHA, MBA

Joe Ramos, RN, BSN

T4: Tuberculosis: Are you ready for multi-drug resistant TB (MDR) or outbreak? Redbird F

The presentation will highlight the need to prepare for having an individual with Tuberculosis Disease. The presenter will provide examples of recent events that show some issues encountered in TB control and prevention and provide lessons learned from those experiences. The presentation will provide information on what activities can be done to prepare for multi-drug resistant TB (MDR) or TB outbreak.

Janette Candido, MD, MPH

T5: Planning for Vulnerable Populations - A Review of the Draft Illinois ESF-8 Plan's Functional Access Needs / At-Risk Populations Annex and Useful Data Resources Redbird G

This session reviews key components in a new Functional and Access Needs (FAN) Annex to the State ESF-8 Plan. The annex outlines state level response and provides guidance to regions / coalitions on meeting the needs of these populations in a disaster. Data sources that can assist in quantifying the FAN / At-Risk Populations will be reviewed as well as discussion on how that information can be accessed for disaster planning purposes. FAN populations may require additional assistance before, during and after a disaster event in communication, transportation, medical care, maintaining independence, etc. Their needs should be integrated at all levels of emergency planning.

Beverly Lyons, RN, MPH

Livia Navon, MS

T6: Disaster Recovery: Resuming Normal Operations Normal Theater

In the wake of disaster, you have to keep one eye on the crisis event and another eye on operations. Knowing when and how to resume operations may not be overly clear. This is particularly true when the crisis is evolving. The presenter will discuss the aftermath of Hurricane Harvey and the lasting effects on the community of Southeast Texas, with particular attention to the effect on healthcare infrastructure. Hurricane Harvey brought rising flood waters, the loss of potable water and the evacuation of a 500-bed acute care facility. The lessons learned from a multi-staged recovery are serving as a blueprint in preparing for future crisis and regional emergencies.

Todd Senters, MHA, FACHE

TRACK KEY

T1: Current Issues & Hot Topics

T2: Health Care Coalitions

T3: CMS Emergency Preparedness Rule

T4: Capacity Building

T5: Functional and Access Needs / At-Risk Populations

T6: Recovery

CLOSING KEYNOTE

10:00 am - 11:30 am

Redbird CD

Michael Hingson

MEET THE SPEAKERS

Junaid Afeef

JD
Director - Targeted Violence Prevention Program
Illinois Criminal Justice Information Authority

Bethanie Albrecht

MS, IPEM
Emergency Preparedness and Response Specialist
LaSalle County Health Department

Shana M. Altman

BS, CHES
Foodborne Disease Coordinator
Illinois Department of Public Health

Saul Ayala

MPA
Supervising Communicable Disease Investigator
Chicago Department of Public Health

Kevin Bernard

BA, MA
Director Safety and Emergency Management Presence
Saint Joseph Medical Center

Jennifer Blazis

BS
HAN Administrator
Illinois Department of Public Health

Michael Borcky

Region 3 Coordinator
Illinois Emergency Management Agency

Claudia Braden

BSN, MPH
RN, Emergency Preparedness Coordinator
Village of Skokie Health Department

Ryan Buckingham

Franklin County EMA

Jan’Nita D. Caine

RN, BSN, MSN
Public Health Nurse IV
Chicago MRC and ESAR-VHP Coordinator
Chicago Department of Public Health

Janette Candido

MD, MPH
Tuberculosis Program Manager
Illinois Department of Public Health

Brad Campbell

Herrin Hospital

Mary Connelly

RN, BSN
Director
IMERT

Dawn Davis

ESAR-VHP, MRC
Volunteer State Coordinator
Illinois Department of Public Health

Darrah A. Dunlap

MPH, LEHP
Water Management Specialist
Illinois Department of Public Health

Tylar Foster

BS
Information Systems Technology HAN / SIREN Program Outreach Specialist
Illinois Department of Public Health

Terry L. Fulk Jr.

RHCC
Manager
Regional Hospital Coordinating Center - Marion

Ellen Genrich

AS, PDS
Emergency Response Coordinator
Boone County Health Department

Ashok Gokhale

PhD, PE
Environmental Engineer
Illinois Department of Public Health

Anita Guffey

EMT-Paramedic, CHCC
Regional Director of Emergency Management
Carle Foundation Hospital

Jonathan Gunn

JD, MICT
Assistant General Counsel IDPH
Illinois Department of Public Health

Michael Hingson

President
The Michael Hingson Group, Inc.

Stacey Hoferka

MPH, MSIS
Epidemiology Informatician
Illinois Department of Public Health

Robert Hyman

MS, NR-P
Good Samaritan Regional EMS System Coordinator
Good Samaritan Hospital

Daniel Hyson

BS, MPH
Volunteer
Franklin Williamson Medical Reserve Corps

Theresa James

EMD, CHCC
Center Director of Emergency Preparedness
Winnebago County Health Department

Jennifer Johnson

JD
General Counsel, IEMA
Illinois Emergency Management Agency

Donald Kauerauf

Assistant Director
Illinois Department of Public Health

Judy Kauerauf

MPH
Communicable Disease Section Chief
Illinois Department of Public Health

Ronda Koch

BS, MS
Director of Emergency Preparedness
Franklin-Williamson Bi-County Health Department

Christine Kosmos

BSN, MS
Director of the Division of State and Local Readiness in the Office of Public Health Preparedness and Response
Centers for Disease Control and Prevention

Angelique Kuehl

Health Educator
Jackson County Health Department

Patricia Kulikauskas

MPH
Emergency Response Coordinator
Stickney Public Health District

Moses Lee

MD
IMERT Medical Director
IMERT

Caitlyn Lutfy

MPH
Health Communication Specialist
Center for Disease Control and Prevention

Adam Lydigsen-Grimes

B.A Student
Augustana Community Health Outreach Organization & Augustana Student - Medical Reserve Corps

MEET THE SPEAKERS

Evelyn Lyons

RN, MPH

EMSC Manager
Illinois Department of Public Health

Amy McCallister

MS

Administrator
Hancock County Health Department

Casey McCartney

Highly Infectious Disease Program
Specialists of Illinois
Carle Foundation Hospital

Mark McCarville

EMT-B

Security Manager / EMS Coordinator
The Clare

Amanda Mehl

RN, MPH

Public Health Administrator
Boone County Health Department

Dacia Meyers

BS

HAN Resource & Training Analyst
Illinois Department of Public Health

Douglas E. Minter

MBA

Vice President of Business Services
Heartland Community College

Jodi Morgan

RN BSN

CIC Public Health Program Specialist
Illinois Department of Public Health

Erin Moritz

PhD

Epidemic Intelligence Service Officer
Illinois Department of Public Health

Livia Navon

MS

CDC Career Epidemiology Field Officer
Illinois Department of Public Health

John Nebel

IPEM, COML

Emergency Management Coor / COMU
Team Lead
DuPage County Office of Homeland
Security and Emergency Management

Todd Nicolson

MA

Senior Public Health Preparedness Planner
Southern Nevada Health District

Dawn Nims

BS, MPH

Communicable Disease Data Manager
Epidemiologist I
Illinois Department of Public Health

Tricia Patterson

MS, MT(ASCP)

All-Hazards Planning Section Chief
Illinois Department of Public Health

Amanda Payne

EMT-P, RRT

Performance Excellence Internal
Champion
Hillsboro Area Hospital

Joe Ramos

RN, BSN

Emergency Response Coordinator
Illinois Department of Public Health

Daniel Reilly

MPA

Owner and Senior Consultant
Resilience International Consultants, Corp

Matthew Ringenberg

MPH

Emergency Response Coordinator
Illinois Department of Public Health

Rick Robbins

Low Enforcement Undersheriff

Montgomery County Sheriffs Office

John Rogan

MS

Principal
Integrated Solutions Consulting

Lori Saathoff-Huber

MPH

General Epidemiologist
Illinois Department of Public Health

Larry Sanders

General Counsel

Rend Lake Conservancy District

Mandy Sebeschak

CRT

RT / Sleep Lab Team Leader, Disaster
Co-Chair
Hillsboro Area Hospital

Todd Senters

MHA, FACHE

Administrator, Service Line Operations
Baptist Hospitals of Southeast Texas

Sabeen Shamsi

MS

Consultant
Integrated Solutions Consulting

Marshall Snyder

Clinical Manager

Fresenius Medical Care

Alana Sorrentino

BS

Emergency Management Intelligence
Officer
Statewide Terrorism & Intelligence Center

Susan Tracy

BSN, RN

Emergency Response Coordinator and
Health Educator
Logan County Department of Public
Health

Anthony Volkert

Area Technical Operations Manager
Fresenius Medical Care

Joy Ward

RN, BSN, RAC-CT, LNHA, NBA

President

Ward & Associates Health Services, Inc.

Matt Warren

Chief of Staff

Franklin County Emergency Management

Katie Weber

MSPH

Emergency Response Coordinator
Will County Health Department

Stephanie Whitten

PM, CHEC III

EMS / Disaster Preparedness Coordinator,
RMERT Chair
Advocate South Suburban Hospital

Shannon Wilson

RN, BSN, MS, CHEC II

Regional Emergency Medical Services
Coordinator - Region 7
Illinois Department of Public Health

POSTER PRESENTATIONS

EMERGENCY RESPONSE PLAN FOR PUBLIC SWIMMING FACILITIES

Ashok Gokhale, PhD, PE

Illinois Department of Public Health

This poster presentation will describe the precautions that ought to be taken and emergency response approaches established by the State of Illinois codes regulating public swimming facilities to ensure that they are in compliance. The Centers for Disease Control and Prevention (CDC) reports that outbreaks of illnesses associated with swimming facilities are very common. Illinois Dept. of Public Health is responsible for monitoring, inspecting and licensing these facilities. Specific topics that will be discussed include: 1) Maintaining specific levels of pH, free residual Chlorine, Bromine, and recirculation turnover rate, and 2) Ensuring drain covers are in compliance with Virginia Graeme Baker (VGB) regulations.

HEALTH AWARENESS & DISASTER PREPAREDNESS: PUBLIC HEALTH OUTREACH DONE BY THE AUGUSTANA COMMUNITY HEALTH OUTREACH ORGANIZATION (ACHOO) AND THE AUGUSTANA STUDENT - MEDICAL RESERVE CORPS (AS-MRC)

Adam Lydigsen-Grimes, BA

Augustana Community Health Outreach Organization & Augustana Student - Medical Reserve Corps

Augustana Community Health Outreach Organization (ACHOO) is a group on campus that provides health awareness and promotes outreach to both students of Augustana College and to the surrounding community. We do this through community service projects and partnering up with different organizations including volunteering at the RiverBend Food Bank and sponsoring events with the American Red Cross including Blood Drives and their "Sound the Alarm" event. A sub-group in ACHOO is the Augustana Student - Medical Reserve Corps (AS-MRC) which is a student unit within the Rock Island County Medical Reserve Corps. AS-MRC events organized to promote disaster preparedness are the Zombie Run & Flu Clinic.

STRENGTHENING COMMUNITY HEALTH AND RESILIENCY THROUGH UNIVERSITY, HEALTH DEPARTMENT, AND COMMUNITY PARTNERSHIPS

Angelique Kuehl

Jackson County Health Department

The Jackson County Health Department, the Southern Illinois University (SIU) MPH program, the SIU School of Medicine Center for Rural Health and Social Services Development and MEDPREP programs, and the SIU Department of Animal Science, Food and Nutrition have partnered to enhance the capacity of the Medical Reserve Corps (MRC) in southern Illinois. This partnership strengthens the connection between public health education and practice, and gives students experiences in public health while providing service to the community. Examples of collaborative activities are provided, along with guidelines to assist others interested in developing similar partnerships.

ESTABLISHING A DEVELOPMENT AND EVALUATION FRAMEWORK FOR HEALTH CARE COALITIONS

Matthew Ringenberg, MPH

Illinois Department of Public Health

The poster presentation will investigate the potential use of the Community Coalition Action Theory as a framework for developing and evaluating Health Care Coalitions.

OPERATION NOAH'S ARK: THE ARCHITECTURE FOR BOOSTING MCM THROUGH FAITH-BASED CLOSED POD AND MRC RECRUITMENT

Ronda Koch, BS, MS

Franklin-Williamson Bi-County Health Department

Operation Noahs Ark (ONA) is a faith-based Closed POD and MRC volunteer recruitment program that boosts medical countermeasures capability. Through the story of Noah, congregations engage as stakeholders in public health emergency preparedness and response. ONA also provides the Architecture for further health-based community programming and outreach. This poster was accepted at 2018 NACCHO Preparedness Summit.

MUMPS TRENDS IN ILLINOIS: MUMPS TRENDS AMONG COLLEGE-AGED YOUNG ADULTS, ILLINOIS, 2006-2014.

Ben Arbise, MPH, CHES

Heather Reid, BS, CHES

According to The Centers for Disease Control and Prevention (CDC), mumps outbreaks in the United States vary from year-to-year and in recent years have occurred among school-aged youth and young adults. Illinois had approximately 1,414 mumps cases reported from 2006 through 2014, with the majority of these cases being in traditional school-aged youth and young adults between the ages of 6 and 22. This poster analysis concentrates on age groups at highest risk for mumps and explores areas in Illinois that are more likely to have youth and young adults interacting in close quarters, such as in a college or university setting and explores potential impacts on surrounding communities.

POSTER PRESENTATIONS

LOCAL HEALTH DEPARTMENT PERSPECTIVE ON THE ZIKA RESPONSE IN ILLINOIS, DECEMBER 2017

Kelly Walblay

Jennifer Layden

Livia Navon, MS

Illinois Department of Public Health

Illinois has a decentralized public health system; therefore, local health departments (LHDs) assume most of the response burden during public health emergencies. Most LHDs have limited communicable disease staff and receive guidance from both the Illinois Department of Public Health (IDPH) and Centers for Disease Control and Prevention (CDC). We evaluated the experience of Illinois LHDs in responding to Zika, an emerging pathogen.

USING EMERGENCY MEDICAL SERVICES (EMS) DATA TO ASSESS PERSONAL PROTECTIVE EQUIPMENT (PPE) REPORTING BY ILLINOIS EMS PROVIDERS IN RESPONSE TO THE 2014–2016 EBOLA OUTBREAK IN WEST AFRICA

Livia Navon, MS

Illinois Department of Public Health

Daniel Lee

Lisa Diep

During the 2014–2016 Ebola outbreak in West Africa, CDC issued guidance for EMS providers on appropriate PPE. We analyzed EMS data to determine if PPE use by Illinois EMS providers increased during the time of heightened concern regarding domestic Ebola transmission (October 2014–June 2015). We hypothesized that for ambulance runs involving patients with infectious symptoms, there would be a greater increase in reported PPE usage than for patients without infectious symptoms.

2018 IDPH Prep Summit has gone mobile!

Get the app on your mobile device now, for free.

<https://guidebook.com/g/2018IDPHPrepSummit/>

- 1 Visit the the listed URL on your device
- 2 Tap the "download" button to get the free Guidebook app
- 3 Open Guidebook and look for the guide: 2018 IDPH Prep Summit

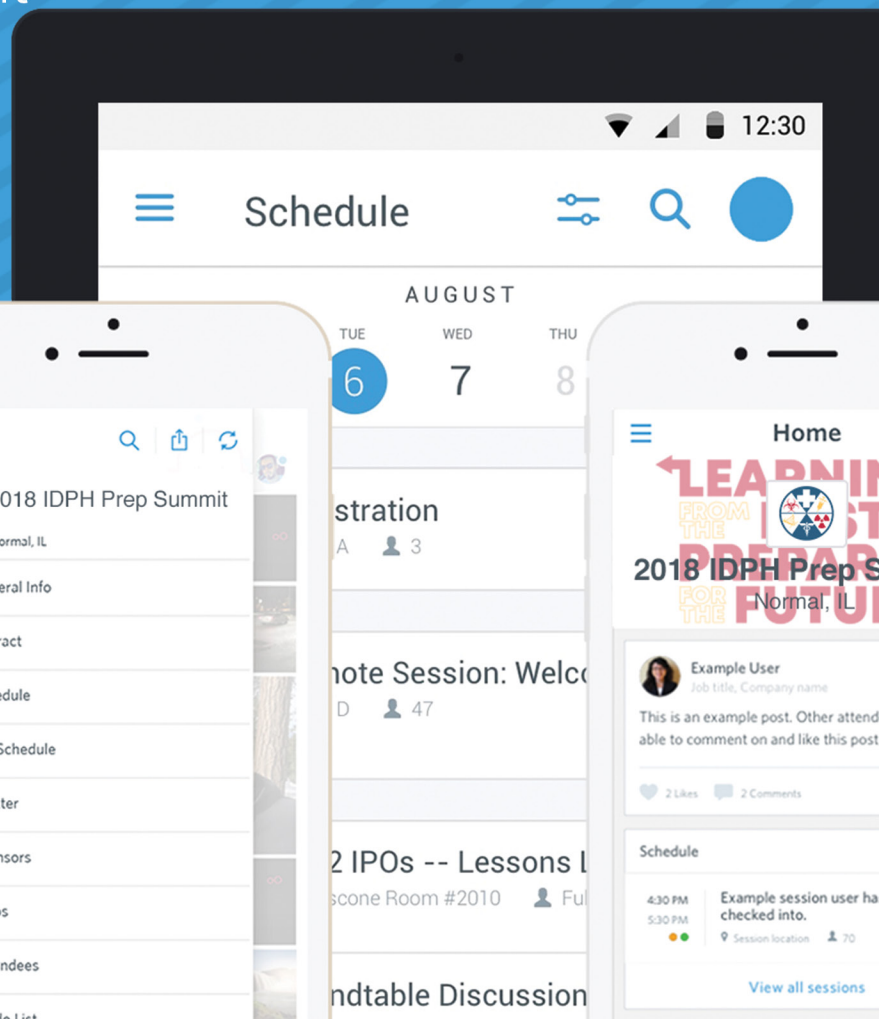

guidebook

THANK YOU

SPONSORS

Special thanks to our sponsors for their support of the 2018 Public Health and Health Care Coalition Preparedness Summit!

GOLD SPONSOR



SILVER SPONSOR



EXHIBITS

Special thanks to our exhibitors for their support of the 2018 Public Health and Health Care Coalition Preparedness Summit!

Benedictine University

DQE

Feel Good, Inc.

IDPH - EMS for Children

IDPH - MRCIL

IDPH - SIREN

Illinois Department of Innovation and Technology

Illinois Helps

Illinois Public Health Association

Illinois Rural Health Association

IMERT

Integrated Solutions Consulting

Med Sled

Ragan Communications

Statewide Terrorism & Intelligence Center

WorldPoint Trauma

Funding for this conference was made possible (in part) by the cooperative agreement award 5U90TP000520-02 from the U.S. Centers for Disease Control and Prevention. The views expressed in written conference materials or publications and by speakers and moderators do not necessarily reflect the official policies of the U.S. Department of Health and Human Services, nor does mention of trade names, commercial practices, or organizations imply endorsement by the U.S. Government.

THANK YOU

2018 SUMMIT PLANNING COMMITTEE

Thank you to the summit planning committee for their guidance, suggestions and efforts that have made this year's summit one that will benefit all in attendance. Their dedication is truly appreciated!

Winfred Rawls, BBA, MBA, MS

Summit Co-Chair

Tammy Moomey

Summit Co-Chair

Michelle Hanneken, MA, IPEM

Steering Committee

David Hopper, BA

Steering Committee

Sandy Szpyrka, RN, BSN

Steering Committee

Dawn Nims, BS, MPH

Chair, Current Issues and Hot Topics

Sue Hecht, RN, BSN, TNS, IPEM, CHEC III

Chair, Health Care Coalitions

Joe Ramos, RN

Chair, CMS Emergency Preparedness Rule

Katie Weber, MSPH

Chair, Capacity Building

Evelyn Lyons, RN, MPH

Chair, Functional and Access Needs / At-Risk Populations

Kevin Gillespie, LEHP

Chair, Recovery

Bethanie Albrecht, MS, IPEM

Greg Atteberry, RN, MSN

Claudia Braden, RN, BSN, MPH

**Brian Churchill, EMIP,
BSHA, CHEC**

**Dawn Davis, RN, BSN,
MSN, APRN-BC**

Terry Fulk

Ellen Genrich, AS, PDS

Debbie Jackson, RN, LNHA

Amy McCallister, MS, CHES

Tricia Patterson, MS, MT(ASCP)

Leslee Stein-Spencer, RN, MS

Scott Swinford

Shannon Wilson, RN, BSN, MS

MARRIOTT HOTEL & CONFERENCE CENTER

SECOND FLOOR

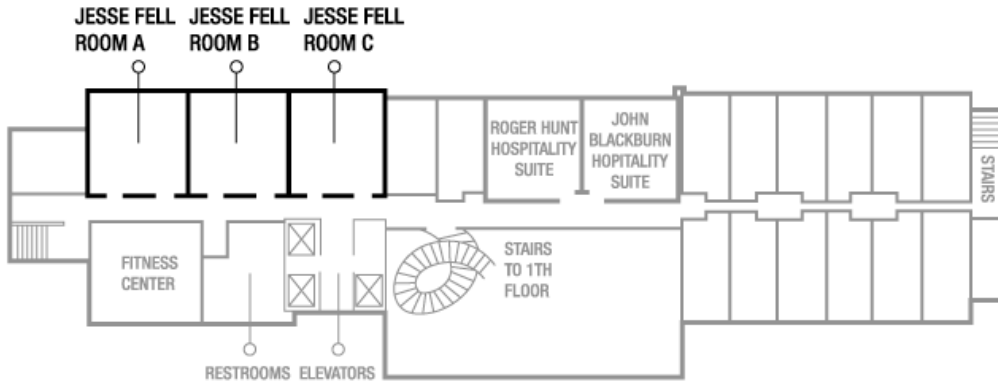

FIRST FLOOR

